

# TOWNSHIP 3 N., RANGE 28 E.W.M.

SCALE 2 IN. = 1 MILE.  
DATED 1932

UMATILLA COUNTY OREGON

CHAS. F. METSKER CIVIL ENGINEER  
215 COMMERCE BLDG. PORTLAND, ORE.  
930 1/2 PACIFIC AVE. TACOMA, WASH.

8

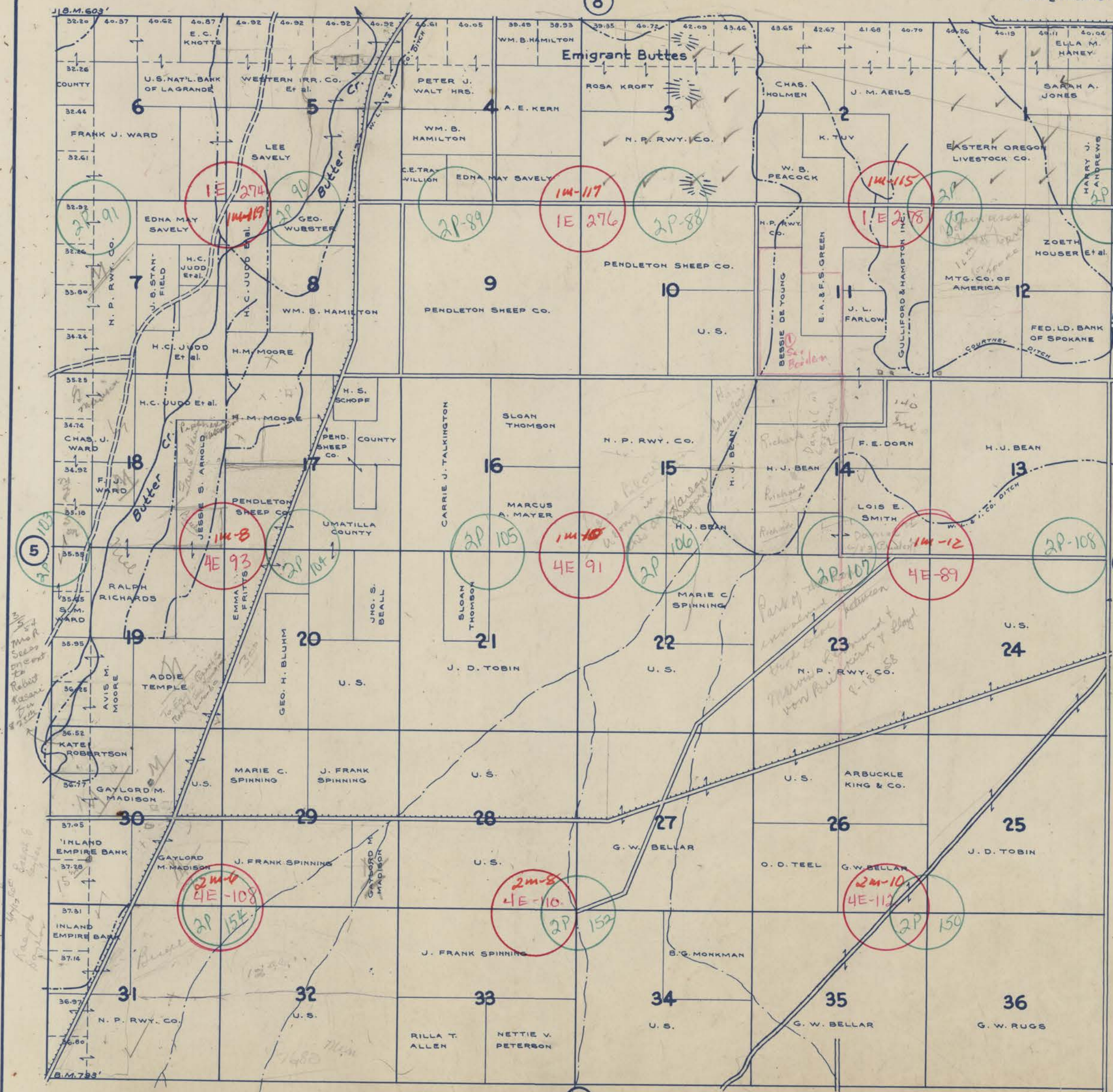

*Mr. M. Cantor sample to Shelton Ex. cross conveyed*

*1/2 acre owned by Phil Emert Purchased in 1947 for \$25,000 - Fair house - some buildings - No value Pasture set up - 3/4 in 7/10/1947 levelled 2/3 better in frequent fields. No lease available*

*In Dec 14 4-26-63 Hammel to Raudaba Martin \$100,000*

- LEGEND-**
- PAVED ROADS
  - STATE HIGHWAYS
  - MARKET ROADS
  - DIRT ROADS
  - INFERIOR ROADS
  - RAILROADS
  - TRAILS
  - INTERMITTENT CREEKS
  - SCHOOLS