

TOWNSHIP 6 N., RANGE 37 E.W.M. UMATILLA COUNTY OREGON

SCALE 2 IN. = 1 MILE
DATED 1932

CHAS. F. METSKER CIVIL ENGINEER
215 COMMERCE BLDG, PORTLAND, ORE.
930 1/2 PACIFIC AVE, TACOMA, WASH.

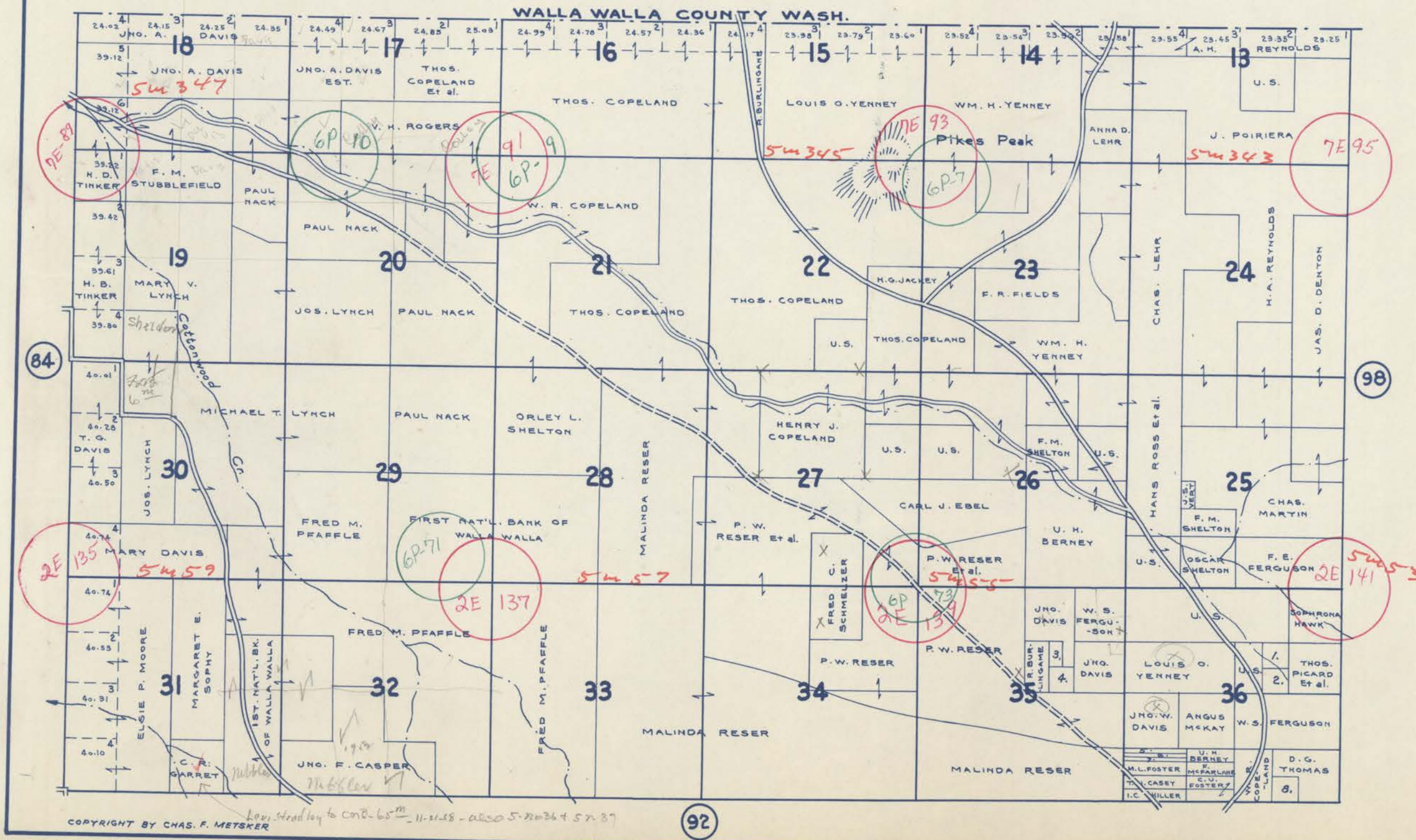

- 1-KNOTT BLUFF FARMING CO.
- 2-E. H. STEBBINS
- 3-F. L. PATTON
- 4-A. D. SEXTON
- 5-C. L. FLOMER
- 6-CLARENCE BERNEY
- 7-LOUIS BECK
- 8-CLAUDE HARRIS

- LEGEND -**
- PAVED ROADS
 - STATE HIGHWAYS
 - MARKET ROADS
 - DIRT ROADS
 - INFERIOR ROADS
 - RAILROADS
 - TRAILS
 - INTERMITTENT CREEKS
 - SCHOOLS

Copyright by Chas. F. Metsker
Louis Steadley to CND-65^m - 11-11-38 - also 5-22-36 + 5-7-37