

This map was prepared for Assessment & Taxation purposes only and was NOT prepared nor is it suitable for legal, engineering or surveying purposes.

SEC 11 T5N R28E WM
UMATILLA COUNTY
1"=400'

5N 28 11
AERIAL PHOTO NO. NZ IP-58 - 60

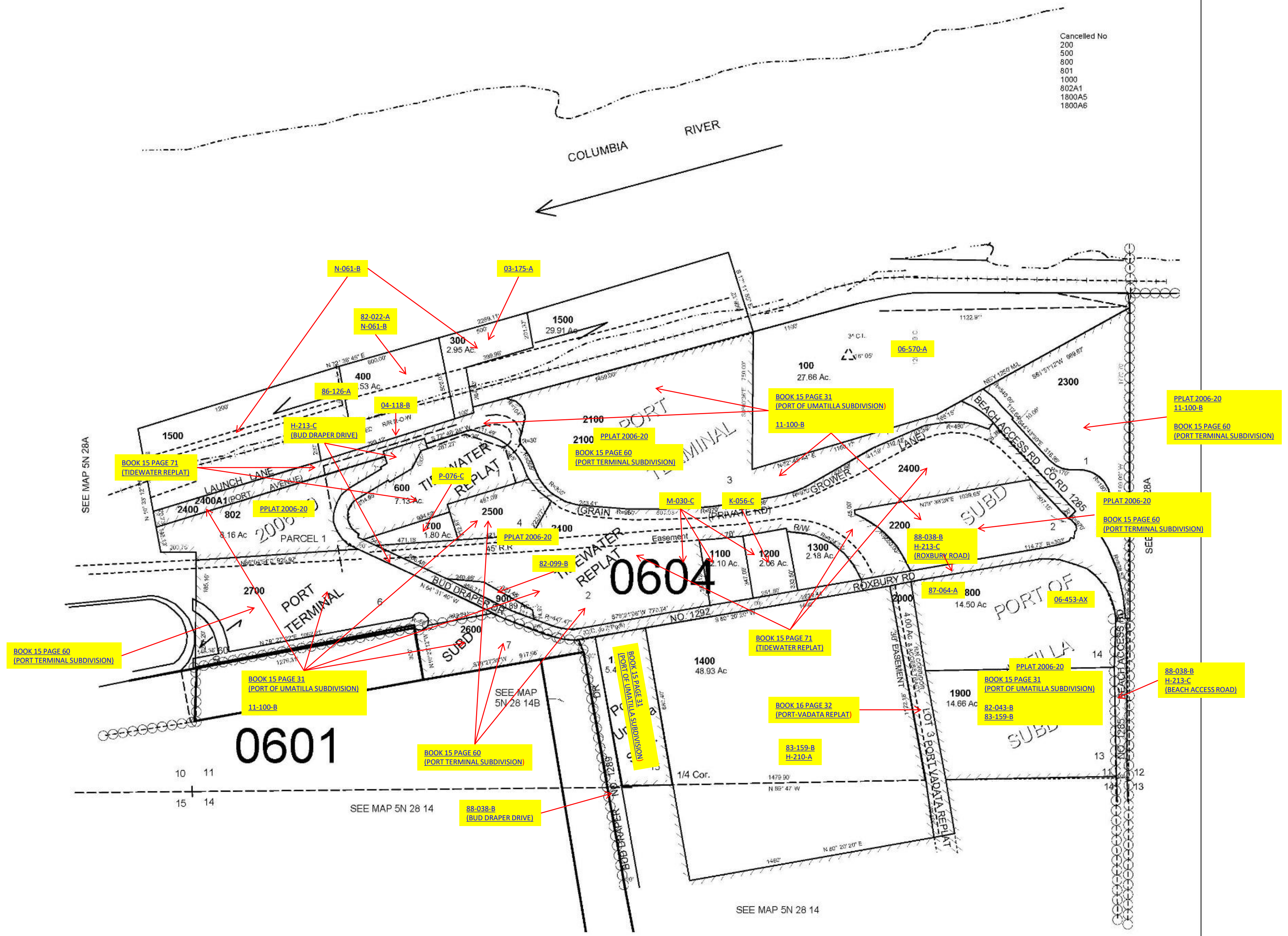

REVISED: 07-20-20

5N 28 11