

KNOW ALL MEN BY THESE PRESENTS, that we, Robert N. Stanfield and Vera Stanfield, husband and wife, of Stanfield, Umatilla County, Oregon, being the owners of all the property shown and included within the attached plat of Coe's First Addition to the Town of Stanfield, do hereby make and declare the annexed plat to be the plat of Coe's First Addition to the Town of Stanfield, Umatilla County, Oregon, said addition being situated on the South Half of Section 32, Township 7 North, Range 29 East of the Willamette Meridian in Umatilla County, Oregon, and do hereby dedicate to the use of the public, without reservation, all the streets, avenues and ways shown upon said plat.

IN WITNESS WHEREOF we have hereunto set our hands and seals this 31 day of DECEMBER 1909

Robert N. Stanfield (SEAL)  
 Vera Stanfield (SEAL)

EXECUTED IN THE PRESENCE OF  
 J. H. Parks  
 Chas. A. Stanfield  
 STATE OF OREGON, )  
 COUNTY OF UMATILLA ) SS.

THIS CERTIFIES, that on this 31 day of December, 1909, before me, the undersigned, personally appeared the above named Robert N. Stanfield and Vera Stanfield, his wife, known to me to be the persons described in and did execute the foregoing instrument of dedication, and acknowledged to me that they executed the same freely and voluntarily for the uses and purposes therein mentioned.

IN TESTIMONY WHEREOF I have hereunto set my hand and official seal, the day and year last above written.  
 J. H. Parks  
 NOTARY PUBLIC FOR OREGON

STATE OF OREGON )  
 COUNTY OF UMATILLA ) SS.

We, the undersigned, hereby certify that we have examined and being sworn the attached plat of Coe's First Addition to the Town of Stanfield, that the same adopted for a city addition is proper, that such addition conforms the block numbers of the plat of the Town of Stanfield, as they same is given on file and record. That the streets and alleys are dedicated to the public use without any reservation or restriction whatever, that all taxes and charges levied against the lands covered by the attached plat have been paid.

DATED PENOLETON, OREGON, DECEMBER 27th 1909.

E. P. ... COUNTY ASSESSOR  
 John W. ... COUNTY SURVEYOR

STATE OF OREGON )  
 COUNTY OF UMATILLA ) SS.

I hereby certify that the attached plat has been approved in accordance with the terms of the foregoing certificate by the County Court of Umatilla County, Oregon, by order thereof made and entered on the 31st day of January 1910.

In testimony whereof I have hereunto set my hand and attached the seal of the said Court, this 31st day of January 1910.

Frank ...  
 COUNTY CLERK AND EX-OFFICIO  
 CLERK OF THE COUNTY COURT OF  
 UMATILLA COUNTY, OREGON.  
 By J. L. ... deputy

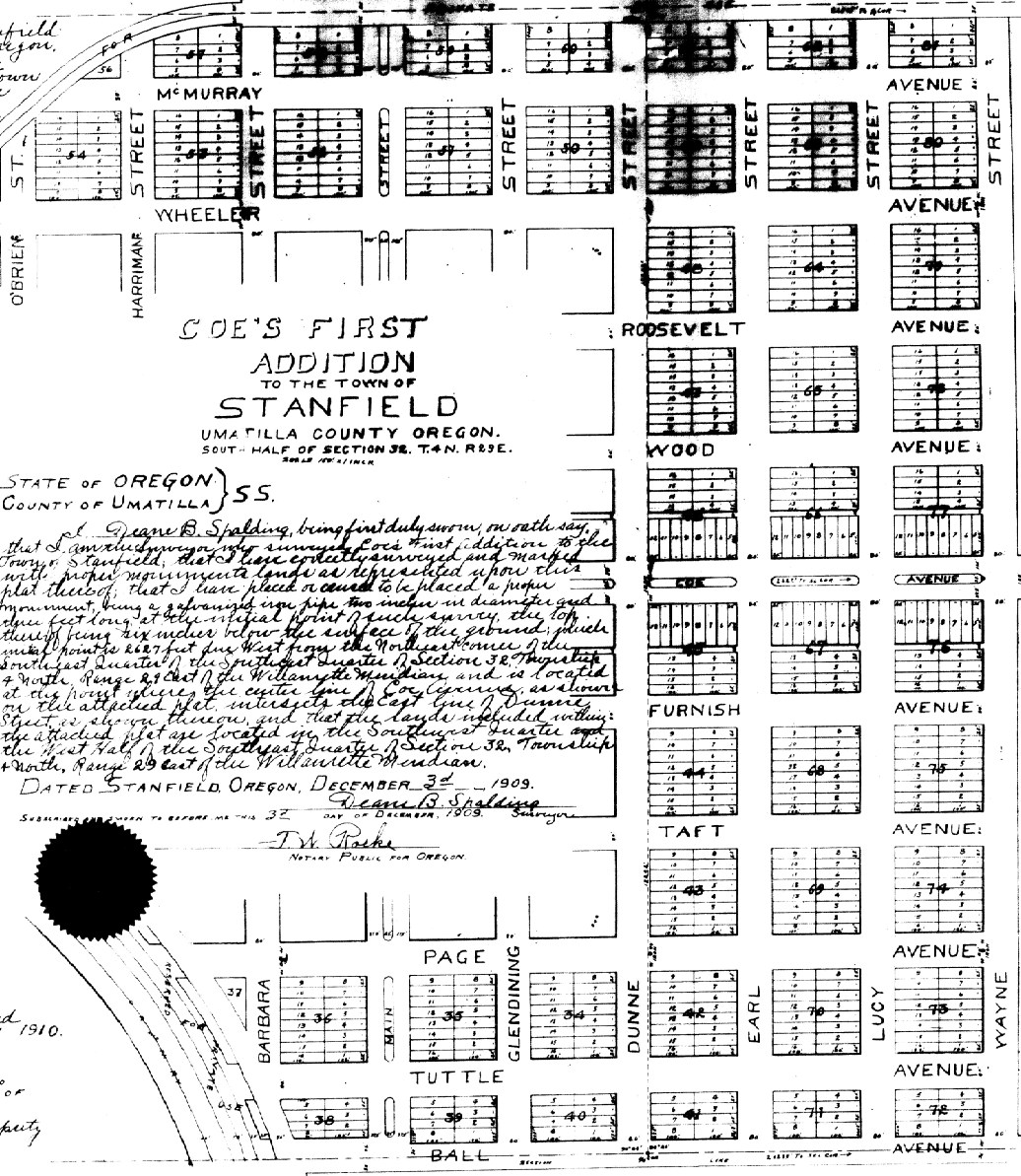

STATE OF OREGON )  
 COUNTY OF UMATILLA ) SS.  
 I hereby certify that the attached plat has been approved in accordance with the terms of the foregoing certificate by the County Court of Umatilla County, Oregon, by order thereof made and entered on the 31st day of January 1910.  
 In testimony whereof I have hereunto set my hand and attached the seal of the said Court, this 31st day of January 1910.

H 33A

BOOK H