

AMENDED RECORD OF SURVEY
AMENDING RECORD OF SURVEY NO. 13-187-B
WITHIN THE SE1/4SE1/4 SECTION 9,
TOWNSHIP 4 NORTH, RANGE 28 EAST, W.M.
UMATILLA COUNTY, OREGON

RECEIVED BY

Umatilla County Surveyor
 Date: 4/10/2014
 Rec'd By: G. Hensley
 No.: 14-031-A

SURVEYOR'S NARRATIVE & CERTIFICATE

THIS SURVEY WAS ORIGINAL MADE AT THE REQUEST OF MORGAN CONSTRUCTION FOR THE PURPOSE OF RETRACING THE EXISTING BOUNDARY SEE RECORD OF SURVEY 13-187-B FOR ADDITIONAL INFORMATION AND BOUNDARY DETERMINATION.

THIS SURVEY WAS PERFORMED TO AMENDED RECORD OF SURVEY NO. 13-187-B, TO CORRECT THE EAST BOUNDARY LINE WHICH SHOWS THE RIGHT-OF-WAY THAT WAS SOLD TO THE STATE OF OREGON IN WARRANTY DEED INST. NO. 2002-4100359. IN THE ORIGINAL SURVEY A CHAIN OF TITLE WAS ORDER AND THE TITLE COMPANY MISSED REPORTING THE WARRANTY DEED TO THE STATE OF OREGON, IN THE COURSE OF ANOTHER SURVEY TO THE SOUTH FOR RAYMOND POGUE THIS RIGHT-OF-WAY DOCUMENT WAS DISCOVERED, IT WAS ALSO DISCOVERED THAT THE BEARING ON THE SOUTH LINE OF SECTION 9 HAD A TYPO AND THIS AMENDED SURVEY WAS PERFORMED.

I LANCE CLARK KING, A REGISTERED PROFESSIONAL LAND SURVEYOR HEREBY CERTIFY THAT THE FIRST MONUMENT ESTABLISHING OR REESTABLISHING A BOUNDARY MONUMENT WAS PLACED ON 3/27/2014, THAT THE ADJOINING PROPERTY AND ALL PROPERTY ACCESSED IN THIS SURVEY WAS DONE IN ACCORDANCE WITH ORS 672.047, THAT THIS SURVEY WAS MADE BY ME, OR UNDER MY DIRECTION, THAT THE MONUMENTS ARE AS SHOWN AND THAT THIS MAP IS A TRUE AND ACCURATE REPRESENTATION OF SAID SURVEY.

CURVE TABLE				
C#	Length	Radius	Delta	Chord
C1	223.82	6561.67	1°57'16"	N0°26'12"E 223.81
C2	138.13	6589.89	1°12'03"	S0°36'20"W 138.12
C3	224.05	6561.67	1°57'23"	N0°26'09"E 224.04

FND ALUMINUM MONUMENT AS PER RECORD ON FILE 1/4 COR. SECTION 9 & 10

66' RW PER COUNTY RECORDS NO DEED DOCUMENTATION FOUND

WARRANTY DEED INSTRUMENT NO. 114173 WARD

INTERSECTION OF SECTION LINE & HWY CENTERLINE
 PC: 22+45.71

28.22' STATE R/W

FND. 5/8" REBAR & CAP PLS 1094 AS PER (R1)

S89°42'22"E 298.28 (R1)

FND. 5/8" REBAR & CAP PLS 61420 AS PER (R1)

C1

CALCULATED NE CORNER NE1/4 SE1/4SE1/4 PER (R1)

WARRANTY DEED INSTRUMENT NO. 2000-3760633 NICACIO ACRES 2.15

FND 1-1/2" ALUM STATE HWY MON

PT: 24+69.53
 S01°24'50"W 5.82
 PC: 24+75.35

10' EASEMENT PER INST. NO. 2003-4290441

28.22' STATE R/W

SET 5/8" REBAR & CAP PLS 61420 THE STATE MON FND IN (R1) WAS DESTROYED DURING CONSTRUCTION ACTIVITIES THE SET REBAR IN (R1) WAS BADLY BENT AND REMOVED DURING THIS SURVEY

N89°42'56"W 295.56 (N89°42'56"W 298.33 (R1))

33' COUNTY R/W

BASIS OF BEARING N00°32'33"W 2643.97 (R1)

FND. 5/8" REBAR & CAP PLS 1094 AS PER (R1)

N0°31'58"W 315.55 (R1)

RAYMOND POGUE WARRANTY DEED INSTR. NO. 1996-222045

CALCULATED SE CORNER NE1/4SE1/4SE1/4 PER (R1)

PT: 26+99.40

FND BRASS MONUMENT AS PER RECORD ON FILE S.E. COR SECTION 9

S89°43'29"E (S89°43'29"W (R1))

16 15

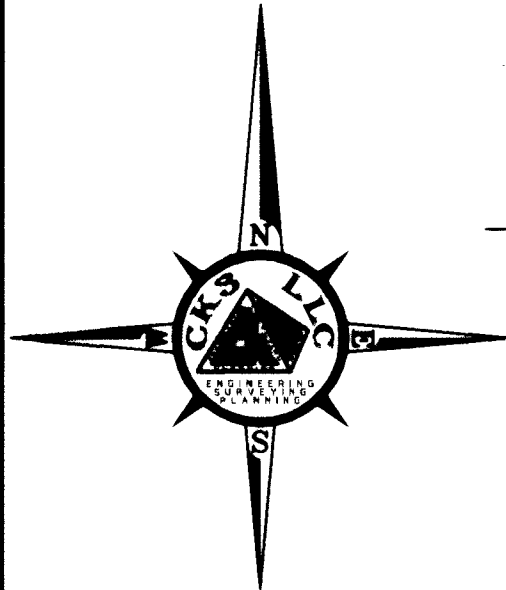

REGISTERED PROFESSIONAL LAND SURVEYOR
Lance Clark King
OREGON
MAY 10, 2011
LANCE CLARK KING
61420

RENEWS: 6/30/2015

LEGEND

- — — — — PROPERTY LINE () DATA OF RECORD
- — — — — RIGHT-OF-WAY LINE (●) FOUND MONUMENT AS NOTED
- — — — — SECTION LINE (○) FOUND 5/8" REBAR
- — — — — HIGHWAY CENTERLINE (●) SET 5/8" REBAR & CAP
- x - x - x - x - FENCE LINE (▲) CALCULATED POINT

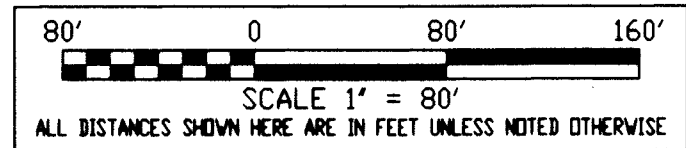

REFERENCES

R1 RECORD OF SURVEY FOR PABLO E. NICACIO BY CK3, LLC SURVEY NO. 13-187-B.

SURVEY FOR: **PABLO E. NICACIO**



CK3, LLC
CIVIL-STRUCTURAL-ELECTRICAL ENGINEERING, SURVEYING & PLANNING
 ONTARIO HERMISTON
 368 SW 5TH AVE. 945 W. ORCHARD AVE.
 ONTARIO OR 97914 HERMISTON OR 97838
 PHN: (541) 889-5411 PHN: (541) 567-2345
 FAX: (541) 889-2074 FAX: (541) 567-2305
 WEB: CK3LLC.NET

CHECKED BY: DKC	DRAWN BY: LCK	APPROVED BY: LCK
DATE: 4/10/2014	DRAWING No. VD13022A-625	REVISED:
SHEET 1 OF 1	JOB No. VD-07004	BK. 0-284