

65
78

S 89° 47' 00" E

1162.81'

166.11' 3996.77' 5.4
89

NW 1/4 NW 1/4 SEC. 8

T. 2 N. R. 33 E.W.M.

N 1° 21' 40" E
1321.27'

1322.11'

S 1° 02' 20" W

1322.23'

N 0° 59' 30" E

1170.22'

N 89° 44' 00" W

residence

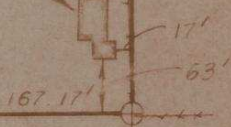

LEGEND

- ⊕ — FND. BRASS CAP
- — SET 5/8" IRON PIN

David H. Kumbier

SURVEY FOR FIRST FEDERAL SAVINGS & LOAN PARCEL IN NW 1/4, NW 1/4, SEC. 8, T. 2 N., R. 33 E.W.M.	WAYNE HARRIS CO. INC.			
	ENGINEERS - SURVEYORS PENDLETON OREGON			
SCALE	1" = 200'	DRN. BY	J.F.S.	DRNG. NO.
DATE	1-17-75	CKD. BY	D.H.K.	75-389

J-56-Ax