

P-12-Ax

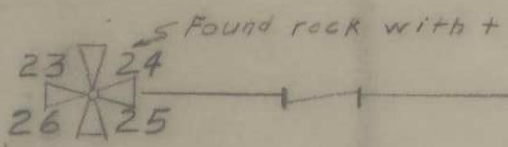

Set 1/2" steel pins all corners

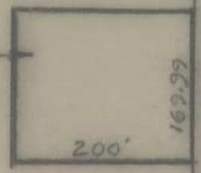

400.0

STATE HIGHWAY No. 11

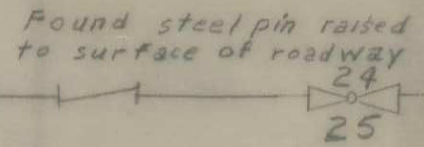

CROCKETT ROAD 40'

Found 1/2" steel pin at Section line

Found spike at intersection of Tum-A-Lum Road.

REGISTERED
PROFESSIONAL
LAND SURVEYOR

Guy W. Streamer Jr.

OREGON
SEPTEMBER 23, 1977
GUY W. STREAMER, JR.
1341

100'

SURVEY FOR
WILLIAM L. LEFORE
SECTION 25 T.6N., R. 35E. W.M.
Scale 1" = 200' Oct. 30, 1977

Survey 894

P-12