

ELMO E. ROBNETT

Registered Land Surveyor

Box 0176
MILTON, OREGON

DESCRIPTIVE TRACT.

MILTON CITY, OREGON.

SCALE 1" = 60' MARCH 1948.

NW 12

STREET.

STREET.

50

60

MILL

STREET

60

QUARTZ

FAIR

80

47

60

60

60

60

40

40

MAIN

280

STREET.

Monument

G-1667

REGISTERED
OREGON
LAND SURVEYOR
Elmo E. Robnett
MARCH 8, 1948
ELMO E. ROBNETT
169

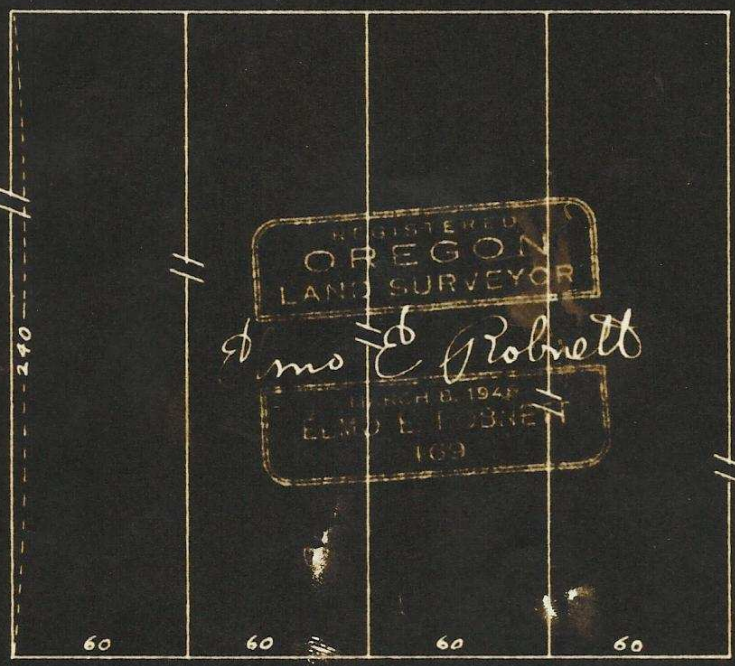

ELMO E. ROBNETT

Registered Land Surveyor

Box 0176
MILTON, OREGON

DESCRIPTIVE TRACT

East of Mill Street between Quartz & Fair Streets in Milton, Oregon

Beginning at a point I had previously set on the East line of Mill Street on the Easterly extended South line of Quartz Street, I ran Southerly along the East line of Mill, 100.0 feet to the Beginning of the property; thence continuing along Mill Street, 70 feet; thence at Right Angles Easterly, 171.66 feet to to the North and South centerline of Section 12; thence Northerly along the North and South centerline, 77.48 feet; thence 204.87 feet Westerly parallel with the South line to the point of Beginning.

All points marked by $\frac{1}{2}$ " iron rods.

12BD
Q-1402-AX