

BASIS OF BEARINGS
 S 89°11'27" E BETWEEN THE BRASS CAPS AT THE SOUTH 1/4 AND SOUTHEAST CORNERS OF FRACTIONAL SECTION 14 (NORTH), T.6N, R.35E, W.M., AS SHOWN ON PENDING PARTITION PLAT LD-6N-220-90, TO BE FILED IN THE OFFICE OF THE UMATILLA COUNTY CLERK.

FD. 3/4" PIPE WITH YELLOW CAP STAMPED: "WA 12896 OR 1059". NE COR. FRAC. SEC. 13. REFER TO UMATILLA CO. SURVEY 86-104-B.
 FD. BR. CAP BURIED 15" STAMPED: 13 18 OREGON
 FD. BASALT STONE IN SQUARE METAL BOX. MILE POST 28. REFER TO LAND CORNER RECORD FILED AT WALLA WALLA CO. AUDITORS', INST. NO. 8701548.

N 89°07'06" W 2667.78' TO 1/2" PIN AT C 1/4 CORNER S.13.
 N 89°23'23" W 2665.82' TO COMPUTED LOCATION FOR C-S 1/16 SECTION 13.
 N 89°39'43" W 2662.73' TO 3/4" PIPE AT S. 1/4 CORNER S.13.
 N 02°25'4" E 844.72' (13.00 CHAINS = 866.00 (R) - GLO)
 N 03°23'4" E 2598.15' (T.6N R.35E)
 N 03°23'4" E 2598.15' (T.6N R.35E)
 SET 2" BRASS CAP ON 1" X 30" PIPE WITH ACCESSORIES. PLEASE REFER TO LAND CORNER RECORDS FILED CONCURRENTLY WITH THIS SURVEY.
 FD. 3/4" PIPE W/ YELLOW CAP STAMPED: "WA 12896 OR 1059" 43' SOUTH OF DIRT ROAD. REFER TO SURVEY 86-104-B. PIPE IS SHOWN TO BE ON RANGE LINE, BUT IS NOT INTENDED TO REPRESENT A SEC. CORNER.

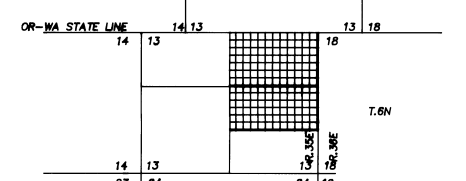

REGISTERED PROFESSIONAL LAND SURVEYOR
 Paul W.P. Tomkins
 OREGON
 JULY 28, 1988
 PAUL W.P. TOMKINS
 2380
 10/9/90

RECEIVED BY
 11-90
 No. 90-0274-B
 SCALE: 1" = 60'
 0 30 60 120

SHEET 1 OF 2
A BOUNDARY LINE ADJUSTMENT
 LOCATED IN THE W. 1/2 OF THE FRACTIONAL NE 1/4, SEC. 13, T. 6N, R. 35E, W.M.
 FOR: MR. LEN HARMS, EXECUTOR OF THE PETER STRANGE ESTATE
 6413 COURT AVE. PASCO, WA. 99301
PAUL W.P. TOMKINS, LAND SURVEYOR
 14 EAST MAIN SUITE 5
 WALLA WALLA, WA. 99362
 (509) 522-4843
 DATE: SEPT., 1990
 SCALE: 1" = 60'

LEGAL DESCRIPTION FOR PARCEL "A"

A PARCEL OF LAND IN THE WEST 1/2 OF THE NORTHEAST 1/4 OF FRACTIONAL SECTION 13, TOWNSHIP 6 NORTH, RANGE 35 EAST, WILLAMETTE MERIDIAN, UMATILLA COUNTY, OREGON, SAID PARCEL BEING DESCRIBED MORE PARTICULARLY AS FOLLOWS:

COMMENCING AT THE NORTHWEST CORNER OF SAID WEST 1/2 OF THE NORTHEAST 1/4 OF SECTION 13; THENCE S 00°00'57" W ALONG THE WEST LINE OF SAID WEST 1/2 OF THE NORTHEAST 1/4 339.48 FEET;

THENCE S 89°29'06" E PARALLEL TO THE OREGON - WASHINGTON STATE LINE 30.49 FT. TO A POINT ON THE EASTERLY RIGHT OF WAY LINE OF TUMALUM ROAD, AS SHOWN ON THE OFFICIAL PLAT OF TUMALUM HEIGHTS ON FILE IN THE RECORDS OF THE UMATILLA COUNTY CLERK, SAID POINT BEING THE TRUE POINT OF BEGINNING FOR THIS LEGAL DESCRIPTION;

THENCE CONTINUING S 89°29'06" E ALONG SAID PARALLEL LINE 556.80 FT.;

THENCE S 13°44'06" W 90.20 FT.;

THENCE S 25°57'06" W 99.15 FT.;

THENCE S 02°46'06" W 117.90 FT.;

THENCE S 06°31'54" E 115.88 FT.;

THENCE S 12°35'50" W 77.05 FT. TO A POINT IN A LINE PARALLEL TO AND 6.0 FT. NORTH OF WHEN MEASURED AT RIGHT ANGLES TO THE SOUTH LINE OF THE NORTHEAST 1/4 OF SAID SECTION 13;

THENCE N 89°07'06" W ALONG SAID PARALLEL LINE 483.55 FT. TO A POINT IN THE EASTERLY RIGHT OF WAY LINE OF TUMALUM ROAD;

THENCE N 00°06'00" E ALONG SAID EASTERLY RIGHT OF WAY LINE 482.42 FT. TO THE TRUE POINT OF BEGINNING FOR THIS LEGAL DESCRIPTION.

SUBJECT TO AN AGREEMENT FOR USAGE OF A DOMESTIC WATER WELL NEAR THE NORTHWEST CORNER OF THAT PARCEL DESCRIBED IN REEL 99 AT PAGE 1879, UMATILLA COUNTY DEED RECORDS.

NARRATIVE

THIS SURVEY WAS PERFORMED AT THE REQUEST OF MR. LEN HARMS, EXECUTOR OF THE ESTATE OF DR. AND MRS. PETER STRANGE TO ADJUST EXISTING TAX LOT LINES PRIOR TO SALE OF A PORTION OF THE STRANGES' PROPERTY. TO LOCATE THE BOUNDARIES OF SAID PROPERTY IT WAS NECESSARY TO LOCATE THE SECTIONAL SUBDIVISION LINES WITHIN FRACTIONAL SECTION 13. AS THE 1/4 CORNER BETWEEN SECTIONS 13 AND 18 AND THE SE CORNER OF SECTION 13 HAD BEEN DESTROYED, THESE NEEDED CORNERS WERE RE-ESTABLISHED DURING THIS SURVEY. THE CENTER OF SECTION 13 WAS FOUND DURING THIS SURVEY IN REASONABLE AGREEMENT WITH ITS POSITION AS NOTED ON THE 1909 PLAT OF THE GRANDVIEW ORCHARD TRACTS (SEE MAP OF SURVEY). THE SOUTHEAST SECTION CORNER WAS ESTABLISHED BY EXTENDING A LINE FROM THE SOUTHWEST CORNER OF SECTION 13 THROUGH THE SOUTH 1/4 CORNER OF SECTION 13 TO AN INTERSECTION WITH A LINE BETWEEN 3/4" PIPES ESTABLISHED BY MUNNS ALONG THE EAST LINE OF SECTION 13 (SEE SURVEY 88-104-B). THE EAST 1/4 CORNER WAS THEN ESTABLISHED AT A PROPORTIONATE LOCATION BETWEEN THE SOUTHEAST SECTION CORNER AND A PIPE ESTABLISHED BY MUNNS AT THE NORTHEAST SECTION CORNER. GOOD AGREEMENT WITH THE IMPROVEMENTS AT THE SOUTHEAST SECTION CORNER WAS NOTED.

IT WOULD APPEAR THAT THE INTENT OF THE LEGAL DESCRIPTIONS THAT CONSTITUTE THE STRANGE PROPERTY WAS TO CREATE THE BLUFF OF THE WALLA WALLA RIVER AS THE EAST PROPERTY LINE. IN MOST AREAS, THE DEED LINE WAS IN GOOD AGREEMENT WITH THIS BLUFF. PLEASE REFER TO THE MAP OF THE SURVEY.

EQUIPMENT USED IN THIS SURVEY INCLUDED A LIETZ ONE SECOND TOTAL STATION WITH COAXIAL EDM HAVING A PRECISION OF 3MM ± 2PPM.

LEGAL DESCRIPTION FOR PARCEL "B"

A PARCEL OF LAND IN THE NORTHWEST 1/4 OF THE SOUTHEAST 1/4 AND THE WEST 1/2 OF THE NORTHEAST 1/4 OF FRACTIONAL SECTION 13, TOWNSHIP 6 NORTH, RANGE 35 EAST, WILLAMETTE MERIDIAN, UMATILLA COUNTY, OREGON, SAID PARCEL BEING DESCRIBED MORE PARTICULARLY AS FOLLOWS:

COMMENCING AT THE NORTHWEST CORNER OF SAID NORTHWEST 1/4 OF THE SOUTHEAST 1/4 OF SECTION 13; THENCE N 00°00'57" E 6.00 FT. ALONG THE WEST LINE OF SAID WEST 1/2 OF THE NORTHEAST 1/4 OF SECTION 13;

THENCE S 89°07'06" E ALONG A LINE PARALLEL AND 6.00 FT. NORTH OF WHEN MEASURED AT RIGHT ANGLES TO, THE NORTH LINE OF THE SOUTHEAST 1/4 OF SAID SECTION 13, 28.80 FT. TO A POINT ON THE EASTERLY RIGHT OF WAY LINE OF TUMALUM ROAD, AS SHOWN ON THE OFFICIAL PLAT OF TUMALUM HEIGHTS ON FILE IN THE OFFICE OF THE UMATILLA COUNTY CLERK, SAID POINT BEING THE TRUE POINT OF BEGINNING FOR THIS LEGAL DESCRIPTION;

THENCE CONTINUING S 89°07'06" E ALONG SAID PARALLEL LINE 483.55 FT.;

THENCE S 12°35'50" W 6.13 FT. TO A POINT ON SAID NORTH LINE OF THE SOUTHEAST 1/4 OF SECTION 13;

THENCE S 00°26'00" W ALONG A LINE PARALLEL TO THE WEST LINE OF SAID SOUTHEAST 1/4 OF SECTION 13 217.58 FT.;

THENCE N 89°23'23" W ALONG A LINE PARALLEL TO THE SOUTH LINE OF SAID NORTHWEST 1/4 OF THE SOUTHEAST 1/4 OF SECTION 13 511.00 FT. TO A POINT IN THE WEST LINE OF SAID NORTHWEST 1/4 OF THE SOUTHEAST 1/4 OF SECTION 13;

THENCE N 00°26'00" E ALONG SAID WEST LINE OF THE NORTHWEST 1/4 OF THE SOUTHEAST 1/4 OF SECTION 13 57.42 FT TO A POINT IN THE EASTERLY RIGHT OF WAY LINE OF THE AFOREMENTIONED TUMALUM ROAD, SAID POINT BEING THE BEGINNING OF A NON-TANGENT CURVE TO THE LEFT, TO WHICH A RADIAL LINE BEARS S 68°27'53" E 430.00 FT.;

THENCE NORTHEASTERLY ALONG SAID CURVE 164.03 FT. TO A POINT TO WHICH A RADIAL LINE BEARS N 89°40'45" E 430.00 FT.;

THENCE N 00°06'00" E ALONG SAID EASTERLY RIGHT OF WAY LINE 7.89 FT. TO THE TRUE POINT OF BEGINNING FOR THIS LEGAL DESCRIPTION.

SUBJECT TO A RIGHT OF WAY EASEMENT FOR AN ELECTRIC TRANSMISSION LINE AS DESCRIBED IN BOOK 137 AT PAGE 109, UMATILLA COUNTY DEED RECORDS.

TOGETHER WITH AN AGREEMENT FOR USAGE OF A DOMESTIC WATER WELL LOCATED NEAR THE NORTHWEST CORNER OF THAT PARCEL DESCRIBED IN REEL 99 AT PAGE 1879, UMATILLA COUNTY DEED RECORDS.

ESTABLISHED BY
11-90
KA
90-074-B

REGISTERED
PROFESSIONAL
LAND SURVEYOR
Paul W.P. Tomkins
OREGON
JULY 26, 1988
PAUL W.P. TOMKINS
2360
10/3/00

A BOUNDARY LINE ADJUSTMENT LOCATED IN THE W.1/2 OF THE FRACTIONAL NE 1/4, SEC.13, T.6N, R.35E, W.M.	
FOR: MR. LEN HARMS, EXECUTOR OF THE PETER STRANGE ESTATE 6413 COURT AVE. PASCO, WA. 99301	
PAUL W.P. TOMKINS, LAND SURVEYOR 14 EAST MAIN SUITE 5 WALLA WALLA, WA. 99362 (509) 522-4843	DATE: SEPT., 1990 SCALE: NONE