

Scale: 1" = 1500'

REGISTERED
 PROFESSIONAL
 LAND SURVEYOR
St. Dennis Church
 1000 N. W. 1st St.
 Astoria, Oregon 97103
 Phone: 325-1111

- LEGEND:**
- Found 2 3/8" Brass Caps, as previously referenced. SEE Co. Monumentation Sheets.
 - Found monuments, as noted. Replaced with 1" x 30" Iron Pipe with 2 3/8" Brass Cap, unless noted otherwise.
 - ⊙ Set 1" x 30" Iron Pipe with 2 3/8" Brass Cap, unless noted otherwise.
 - Set 5/8" x 30" rebar with 2" Aluminum Cap.
 - [00] of Record. Davenport's original 1861 Survey, Contract #101. TOWNSHIP LINE Gates, 1858, Contract #04.
 - (000) of Record. As noted.

Survey for **UMATILLA COUNTY**
 In SW 1/4 T4N, R29E, W. M.,
 Sections 19, 20, 21, 22, 23, 29, 30, 31, 32 & 33
 Umatilla County, Oregon
 3/9/95 Job #1994-CO
 Edwards Surveying P.O. Box 763
 503-567-3336 Hermiston, Oregon 97838

DESIGNED BY
 Checked by Surveyor
 Date: 4-95
 Initials: KK
 No: 95-60-B

NARRATIVE

The purpose of this survey is to monument the G.L.O. Corners of the SW Quarter of T 4 N, R 29 E, W.M. Umatilla County, Oregon, under contract with Umatilla County (Area 1994-1 Public Monumentation). The west Range line was originally surveyed by Campbell in 1860 under contract #95. The township was surveyed by Davenport in 1861 under contract #101. The south Township line was surveyed by Gates under contract # 84 in 1859. The monuments set in all of those surveys were posts in mounds with charred stakes. No original evidence was found as there are roads along most section lines and the remainder is farm land.

I used existing monuments for about 1/3rd of the corners.

To set the NE cor. of Sec. 32 I projected the east line of said section north from the E 1/4 cor. as Fraley did in his 1950 survey. That location falls 1 foot east of Fraley's location when measured from the west but lies 9 to 14 feet west of a proportional location.

The B.C. NW cor. of Sec. 32 was found by Krumbein in 1973 Co. # 1-21-C but it is stamped 1979 and lies about 23 feet west of its proportional location and of Frayleys location. I did not change it because several surveys and two subdivisions were done using that corner. "VANTAGE NORTH" and "STANFIELD HEIGHTS".

The most radical change from an existing corner is the NE cor. of Sec. 29. I set it by proportion E-W and just picked a north location which would keep Feedville road pavement in the R/W and also match improvements in Sec. 28 (the north fence of the cemetery). My corner is about 25 feet North and 73 feet West of one set in 1975 by, I believe, Wayne Harris.

The eastings of the SE cor. Sec. 33 is the centerline of a farm lane. If it were set to the East or West the distances to County Roads 1/2 mile East and West would not match the distance of the original survey as well as my location does.

The south 1/4 cor. of Sec. 33 was set by proportion East-West but set 8 feet south of a strait line to keep the existing County Road in the R/W.

I changed the S 1/4 cor. of Sec. 32 because I believe it was set by single proportion and does not match existing monuments and improvements. I could not read the stamps but the B.C. was found as early as 1974 by Krumbein in Sur. # 1-30-A. I set my monument 4.17 feet South based on the 1909 plat of COE'S 1 ST ADD. TO TOWN OF STANFIELD. My location will also move the surveyed line South to the apparent property line and the line of possession for the north line Fisher's property which Ron McKinnis recently surveyed just south of the 1/4 corner in Section 5.

The N 1/4 and E 1/4 of Sec. 30 and the S 1/4 of Sec. 31 were all set by Krumbein in 1980 Survey # S-158 in place of "wagon axles". All three are exact single proportion. I did not use the one at the S 1/4 of 31 because it missed all improvements (fences, roads, etc.). I used the B.C. set by me in a 1988 survey for A.E. Staley Manufacturing at the intersection of Echo Meadows Road and Co. Rd. # 1341 which was surveyed in 1884 as Co. Rd. # 172 Vol. "F" Page 237.

I believe Edwards Road and Feedville Road in the area of Sections 20,21,28,&29 were built within the last 30 years without the section lines being properly established. They are as much as 145 feet from the Section lines they are suppose follow.

This survey was conducted with a one and two man survey crew using a Pentax TH E 100 and a Pentax MD 14 connected together to make a total station.

RECEIVED BY

Umatilla County Surveyor

Date 4-15

By KK

No. 95-60-B

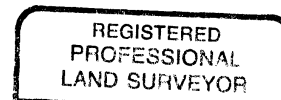

G. Dennis Edwards

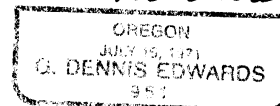

RENEWS 12/31/96