

# RECORD OF SURVEY

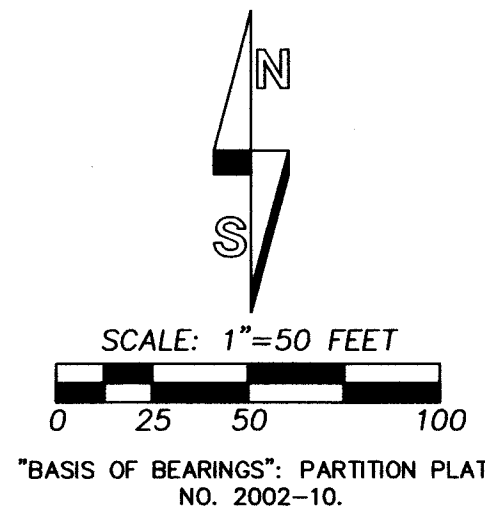

OWNER: HALLMAN  
REEL 212, PAGE 1779,  
INST. NO. 1991-167281,  
UMATILLA COUNTY  
DEED RECORDS.

EXISTING POWER TRANSMISSION LINE EASEMENT,  
RECORDED AS INSTRUMENT NO. 1959-219240, AT  
BOOK 255, PAGE 601, OFFICE OF COUNTY RECORDS.  
EASEMENT LANGUAGE PROVIDES FOR TRIMMING OF  
TREES, BRUSH AND TIMBER WITHIN 15' OF TRANSMISSION  
LINE AND CUTTING AND REMOVAL OF TREES OUTSIDE  
OF THE 15' STRIP WHICH MIGHT ENDANGER THE  
TRANSMISSION LINE.

NORTH LINE SOUTHWEST QUARTER  
OF SECTION 2 PER SURVEY NO.  
R-23-B AND PARTITION PLAT NO. 2002-10.

N.W. JOHNS LANE  
(A.K.A. COUNTY ROAD NO. 1003)

LINE NO.	BEARING	DISTANCE
L1	S 89°18'23" E	30.01'
L2	N 00°41'10" W	20.01'
L3	S 89°18'50" W	30.00'

30 FOOT RIGHT-OF-WAY DEDICATED  
TO CITY OF PENDLETON BY DEDICATION  
DEED RECORDED AS INSTRUMENT NO.  
1998-3400004, OFFICE OF COUNTY  
RECORDS.

COUNTY ROAD NO. 1003

N.E. 2ND STREET

N.E. 3RD STREET

RIGHT-OF-WAY DEDICATED TO  
CITY OF PENDLETON BY DEDICATION  
DEED RECORDED AS INSTRUMENT NO.  
1999-3580391, OFFICE OF COUNTY  
RECORDS.

POTENTIAL FUTURE  
PARCEL LINES—NO  
PARCELS ARE CREATED  
BY THIS SURVEY.

POTENTIAL FUTURE  
PARCEL LINES—NO  
PARCELS ARE CREATED  
BY THIS SURVEY.

LANDSCAPED AREA ENCLOSED  
23' ONTO SURVEYED PROPERTY,  
NORTH OF MONUMENT SET.

SET RAILROAD SPIKE  
STAMPED "PLS 1106"  
IN PAVEMENT. PAVEMENT  
ENCROACHES 4.3'± ONTO  
SURVEYED PROPERTY, NORTH  
OF THIS MONUMENT.

OWNER: NEISTADT  
REEL 262, PAGE 73,  
INST. NO. 1994-200232,  
UMATILLA COUNTY  
DEED RECORDS.

OWNER: LIGHTBURN  
REEL 404, PAGE 327,  
INST. NO. 2002-4040327,  
UMATILLA COUNTY  
DEED RECORDS.

OWNER: FLATT  
REEL 483, PAGE 564,  
INST. NO. 2005-4830564,  
UMATILLA COUNTY  
DEED RECORDS.

OWNER: SHAW  
REEL 162, PAGE 527,  
INST. NO. 1988-135549,  
UMATILLA COUNTY  
DEED RECORDS.

## LEGEND

- - FOUND MONUMENT AS NOTED.
- - SET 5/8" BY 24" REBAR WITH 1 1/4" YELLOW PLASTIC CAP MARKED "OR PLS 1106 WA PLS 17372", UNLESS OTHERWISE NOTED.
- ✠ - 1/4 SECTION CORNER MONUMENT AS NOTED.
- x - CALCULATED POINT ONLY, NOT SET OR FOUND.
- (XOX) - RECORD DIMENSION SHOWN ON PARTITION PLAT NO. 2002-10.
- L0 - INDICATES LINE TOO SHORT TO ANNOTATE, SEE LINE TABLE.
- ⊖ - POWER POLE.

## FOUND MONUMENT NOTES:

- Ⓐ - FOUND 5/8" REBAR PROTRUDING FROM UPROOTED MASS OF CONCRETE.
- Ⓑ - FOUND 5/8" REBAR WITH ALUMINUM CAP MARKED "PLS 933", SET FLUSH IN CONCRETE. THIS MONUMENT BEARS S 86°41' E, 2.15' FROM CORNER POINT.
- Ⓒ - FOUND 5/8" BENT REBAR, (NO CAP), PROTRUDING 8" FROM CONCRETE. TIED MONUMENT WHERE IT ENTERS CONCRETE. THIS MONUMENT BEARS S 07°45' E, 0.84' FROM CORNER POINT.
- Ⓓ - FOUND 5/8" REBAR WITH ALUMINUM CAP MARKED "PLS 933", PROJECTING 18" FROM CONCRETE. BASE OF THIS MONUMENT IS AT RECORD POSITION SHOWN ON PARTITION PLAT NO. 2002-10.
- Ⓔ - 1/4 CORNER COMMON TO SECTIONS 2 & 3. FOUND 2 1/2" BRASS CAP ON GALV. IRON PIPE, CAP BURIED 6" BELOW ROAD SURFACE. MONUMENT ESTABLISHED ON SURVEY NO. R-23-B.
- Ⓕ - FOUND 5/8" REBAR WITH ALUMINUM CAP MARKED "PLS 933", PER PARTITION PLAT NO. 2002-10.
- Ⓖ - FOUND 5/8" REBAR WITH YELLOW PLASTIC CAP MARKED "OR PLS 1106 WA PLS 17372" PER PARTITION PLAT NO. 2002-26.

## NARRATIVE:

THIS SURVEY WAS MADE AT THE REQUEST OF TED CARNER TO IDENTIFY THE BOUNDARY OF A TRACT OF LAND DESCRIBED AS "EXHIBIT C" IN COUNTY ASSESSOR'S UNRECORDED FILE DATED 4-3-95. THE BOUNDARY OF THE SURVEYED TRACT IS ALSO SHOWN ON UMATILLA COUNTY PARTITION PLAT NO. 2002-10.

THE NORTH BOUNDARY OF THE TRACT IS ALONG THE NORTH LINE OF THE SOUTHWEST QUARTER OF SECTION 2, AS DETERMINED BY BOUNDARY SURVEY FOR MILLS-BARNETT, RECORDED AS SURVEY NO. R-23-B, IN 1980. IT IS NOTED THAT IN 1988, THE ORIGINAL CORNER AT THE EAST 1/4 CORNER OF SECTION 2 WAS RECOVERED AND REMONUMENTED. THIS ORIGINAL CORNER BEARS SOUTH 06° EAST ±, 26.75 FEET FROM THE CORNER ESTABLISHED ON SURVEY NO. R-23-B. ALL RECORD SURVEYS AND DEED DESCRIPTIONS IN THIS AREA OF SECTION 2 ARE REFERENCED TO THE EAST 1/4 CORNER POSITION PER SURVEY NO. R-23-B, AND I HAVE HELD THAT POSITION FOR THIS SURVEY.

THE WEST BOUNDARY OF THE SURVEYED TRACT IS THE EAST LINE OF RIGHT-OF-WAY DEDICATED TO THE CITY OF PENDLETON IN INSTRUMENT NO. 1999-3580391, OFFICE OF COUNTY RECORDS.

THE EAST AND SOUTHERLY BOUNDARIES OF THE SURVEYED TRACT WERE HELD ALONG THE RECORD DESCRIPTION LINES OF RECORD DEED CONVEYANCES.

SEVERAL EXISTING MONUMENTS WERE FOUND NEAR THE BOUNDARY OF THE SURVEYED TRACT, AS NOTED ON THE MAP. PARTITION PLAT NO. 2002-10 CALLED THE ORIGIN OF THE MONUMENTS AS SURVEY NO. S-49B. THESE MONUMENTS DO NOT SHOW ON RECORD SURVEY NO. S-49B, THAT REFERENCE IS IN ERROR. WE RESEARCHED RECORDS AT THE UMATILLA COUNTY SURVEYOR'S OFFICE AND COULD NOT FIND A RECORD SURVEY SUPPORTING THE ORIGIN OF THE MONUMENTS. MOST OF THESE MONUMENTS ARE SUBSTANTIALLY OUT OF POSITION AS NOTED ON THIS MAP. THE DISTURBED MONUMENTS WERE LIKELY MOVED FROM THEIR ORIGINAL POSITIONS DURING LOT DEVELOPMENT AND THEN PLACED IN THEIR PRESENT POSITIONS AND CONCRETED IN BY UNKNOWN PERSONS.

THE CONTROL SURVEY WAS MADE BY A 2 PERSON CREW USING TRIMBLE 5700 GEODETIC G.P.S. RECEIVERS OPERATED IN REAL TIME KINEMATIC MODE AND WITH A SOKKIA SET 4B FIVE SECTION TOTAL STATION. NEW MONUMENTS WERE ESTABLISHED BY G.P.S. REAL TIME KINEMATIC METHODS OR BY RADIAL METHODS WITH TOTAL STATION.

REGISTERED  
PROFESSIONAL  
LAND SURVEYOR

*William R. Wells*

OREGON  
JULY 22, 1977  
WILLIAM R. WELLS  
1106  
RENEWS 6/30/06

WILLIAM R. WELLS, PLS  
2602 N.E. RIVERSIDE PLACE  
P.O. BOX 1696  
PENDLETON, OR 97801  
PHONE: (541) 276-6362

DATE: 07/05 DR. BY: JMW  
CK. BY: WRW NO: 05-1018

PROJECT:  
SURVEY FOR:  
**TED CARNER**  
LOCATED IN THE NW1/4 OF  
THE SW1/4 OF SECTION 2,  
T2N., R32E., W.M.,  
CITY OF PENDLETON,  
UMATILLA COUNTY, OREGON.

Umatilla County Surveyor: 05-156-B

Date: 8-05  
Rec'd by: JK  
No: 05-156-B