

DETAIL

of adjustment
between Tax
Lot 400 and
Tax Lot 2000.

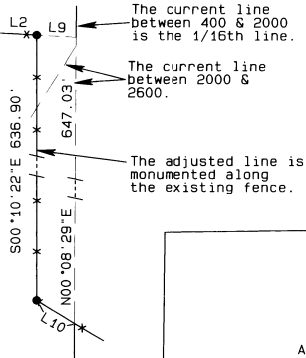

Current Deed Documents
Reel 533, Page 491 - Tax Lot 400
Reel 533, Page 491 - Tax Lot 2000
Reel 60, Page 423 - Tax Lot 2600

**A BOUNDARY ADJUSTMENT SURVEY IN THE
S. 1/2 OF THE N.E. 1/4 AND THE N. 1/2 OF THE S.E. 1/4
OF SECTION 15, T2N, R31E.**



REMAINDER OF
Tax Lot 2N31 400
UNSURVEYED
Adjusted Area = 1066.77 Acres

REMAINDER OF
Tax Lot 2N31A 2000
UNSURVEYED
Adjusted Area = 174.16 Acres

NARRATIVE OF SURVEY

This survey was performed at the request of both Ted and Robert Forth. The purpose of the survey was to monument and described the adjusted boundary of the tax lots as shown. Tax Lots 400 and 2000 were both large enough to remain unsurveyed. The acreage shown as the remainder for Tax Lot 400 is based on the end result of another boundary adjustment that is being currently considered by the Umatilla County Planning Department. The final area for Tax Lot 400 assumes the approval of that boundary adjustment request. The adjusted area for Tax Lot 2000 was arrived at by subtracting the total net change between the tax lots as shown from the acreage for Tax Lot 2000 as shown on the current Assessor's map 2N31A which bears the date of April 14, 2008. The current legal description for Tax Lot 2600 calls for the south boundary to be the "Northerly right of way line" of the Old Oregon Trail Highway. I retraced the highway for approximately 3 miles and had difficulty getting the alignment to conform to the record data found in the right of way map. Because of this difficulty, I held the "as-built" location of the roadway based on the physical centerline of the paved surface and calculated the curve data shown on this map using a "best-fit" solution. The location of the rest of the boundary for Tax Lot 2600 is based on ties to the monuments from County Survey 06-462-C.

Note: The strip of land between the 1/16th line and the existing fence will be transferred to Tax Lot 2000 to avoid creating an unusable strip. See the Detail.

This existing road will have an easement across both tax lots.

SE 1/4 OF THE NE 1/4
OF SECTION 15

Tax Lot
2N31A
2600
Adjusted Area
10.23 Acres

Location of
Stock Water Tanks

LEGEND

- FOUND BRASS CAP SET UNDER UMATILLA COUNTY SURVEY 06-462-C.
- SET A 5/8" x 24" IRON REBAR W/ A 1/8" ORANGE PLASTIC CAP STAMPED WTS AND 56295LS.
- SET A PK NAIL WITH A 2" BRASS WASHER STAMPED WTS AND 56295LS IN THE ASPHALT.
- COMPUTED POINT
- R1 COUNTY SURVEY 06-462-C
- R2 O. W. R. & N. RAILROAD RIGHT OF WAY MAP
- R3 ROAD NOTES FOR COUNTY Rd. No. 799

REGISTERED
PROFESSIONAL
LAND SURVEYOR

Stephen K. Haddock
OREGON
JULY 9, 2001
STEPHEN K. HADDOCK
56295LS
RENEWS 6-30-11

BASIS OF BEARINGS

Bearings were determined by GPS observations on the north line of Tax Lot 2600 and using a rotation of 1°07'16" clockwise to true bearings.

CURVE TABLE

CURVE No.	ARC	DELTA	RADIUS	CHORD	BEARING
C1	318.30'	09°19'56"	1954.22'	317.95'	N70°59'20"W

LINE TABLE

LINE No.	BEARING	DISTANCE
L1	N25°16'11"E	107.70'
L2	S86°49'08"E	55.75'
L3	S61°09'30"E	125.51'
L4	S31°55'51"E	55.70'
L5	S71°56'01"W	92.58'
L6	S55°51'24"E	42.09'
L7	S48°48'46"E	134.55'
L8	S39°18'09"E	130.99'
L9	S86°49'08"E	22.35'
L10	S58°49'52"E	21.98'

RECEIVED BY
Umatilla County Surveyor
Date: 7/10
Rec'd By: JG
No.: 10-113-13

SURVEY FOR
FORTH RANCHES
41257 RIETH ROAD
PENDLETON, OR 97801

LOCATION: Sections 14 & 15, T2N, R31E, W.M.,
Umatilla County, Oregon

PROJECT DATE: February 9, 2008

Project No. 09-23 SCALE: 1" = 200'

WITNESS TREE SURVEYING
Stephen K. Haddock, PLS
P.O. Box 6
Pilot Rock, Oregon 97868
(541) 443-2922