

SECTION 35
T5S R29E
U.S.

SECTION 36
T5S R29E
U.S.

SECTION 31
T5S R30E
U.S.

SECTION 32
T56 R30E
U.S.

SECTION 1
T6S R29E
U.S.

SECTION 5
T6S R30E
PVT.

SECTION 4
T6S R30E
PVT.

SECTION 6
T6S R30E
PVT.

SECTION 7
T6S R30E
PVT.

SECTION 12
T6S R29E
U.S.

SECTION 13
T6S R29E
U.S.

SECTION 18
T6S R30E
U.S.

MORROW COUNTY

UMATILLA COUNTY

CC LIES 11.43' 3.484 m.
NORTH OF STD. PARALLEL

1ST STANDARD PARALLEL SOUTH

BASIS OF BRNG: SOLAR OBSERVATION
MEAN MAGNETIC DECLINATION 20° E

I, WAYNE O HARRIS, A REGISTERED LAND SURVEYOR IN THE STATE OF OREGON, HEREBY CERTIFY THAT THIS PLAT AND THE NOTES HEREON, OR ATTACHED, ARE A CORRECT REPRESENTATION OF A SURVEY PERFORMED DURING JUNE-OCTOBER, 1979, FOR THE U.S. FOREST SERVICE, IN ACCORDANCE WITH THE STATUTES OF THE STATE OF OREGON AND WITH THE ARTICLES OF MY CONTRACT.

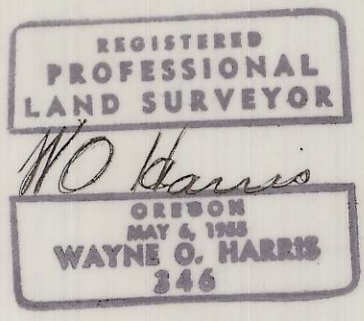

LEGEND

- CORNER FOUND
 - CORNER SET AT PROPORTIONATE DISTANCE
- ALL MONUMENTS SET IN THIS SURVEY ARE 32" x 2" FLANGED IRON PIPES WITH BRASS CAPS MARKED ACCORDING TO THE MANUAL OF INSTRUCTIONS, 1973, AND SPECIAL INSTRUCTIONS FROM THE U.S. FOREST SERVICE
- CORNER MONUMENTATION RECORDS ARE FILED WITH THE COUNTY SURVEYOR OF UMATILLA COUNTY ON U.S. FOREST SERVICE FORM NO. RG-7100-57

RECORD OF SURVEY PLAT
FOR U.S. FOREST SERVICE
TOWNSHIPS 5 AND 6 SOUTH, RANGES
29 AND 30 EAST, WILLAMETTE MERIDIAN
UMATILLA COUNTY, OREGON

Q-1171-B

WAYNE HARRIS Co. Inc.		SURVEYORS		PENDLETON, ORE.	
SCALE	DATE	DRN.	CHK.	DWG. NO.	
1"=1000'	10-10-79	FLM	<i>WHS</i>	79-170-B	