

FD. 2 1/2" BRASS CAP, AS SHOWN ON SURVEY 90-64-B, IN 7" SQUARE METAL BOX AT N 1/4 CORNER SEC. 36

BASIS OF BEARINGS.
 N87°44'59"E ALONG THE MONUMENTED NORTH LINE OF THE NORTHWEST QUARTER OF SEC. 36, T.6N, R.36E, W.M., AS SHOWN ON SURVEY 03-023-C.

LEGEND

- SECTION OR SECTION SUBDIVISION LINE
- HIGHWAY CENTERLINE
- RIGHT OF WAY LINE
- EASEMENT BOUNDARY
- OVERHEAD POWER LINE
- PARCEL BOUNDARY
- ☒ TELEPHONE PEDESTAL
- FOUND SURVEY MONUMENT
- CALCULATED POINT NOT FOUND OR SET
- SET 5/8" X 30" REBAR WITH YELLOW CAP STAMPED "HDJ"
- FOUND IRON PIN SET BY OTHERS

NARRATIVE
 THIS PROJECT WAS PERFORMED AT THE REQUEST OF MICHAEL ANDERSON, OWNER OF THE FAR WEST MOTEL, TO LOCATE THE PROPERTY LINES THEREOF.
 THE PROPERTY CONSISTS OF TWO PARCELS, ACQUIRED AT SEPARATE TIMES. DEED REFERENCES ARE SHOWN HEREIN. WE HAVE SET PROPERTY CORNERS FOR EACH PARCEL.
 AS SHOWN HEREIN, I HAVE HELD THE BRASS CAP SET BY DAVE KRUMBEN IN 1981 FOR THE CENTER 1/4 CORNER, REGARDLESS OF THE FACT THAT IT IS NOT SET AT THE INTERSECTION OF THE LINES BETWEEN THE OPPOSING 1/4 CORNERS, AND HAVE ESTABLISHED THE BLOCKS WITHIN LOUNDAGIN TRACT AS ALIQUOT PARTS OF THE NORTHWEST QUARTER OF SECTION 36.
 THIS SURVEY WAS PERFORMED AS A REAL TIME KINEMATIC SURVEY USING TRIMBLE DUAL FREQUENCY GPS RECEIVERS HAVING A PRECISION OF ONE CENTIMETER ± 1 PPM. MONUMENTS WERE VISITED IN AUGUST, 2016.

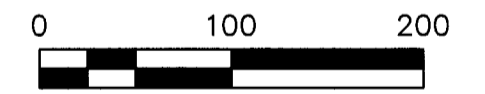
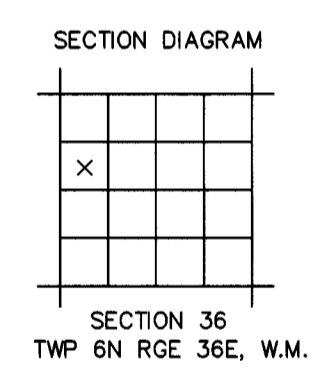

RECEIVED BY
 Umatilla County Surveyor
 Date: 8/17/16
 Rec'd By: [Signature]
 No.: 16-086-C

LINE	BEARING	DISTANCE
L1	S88°05'01"W	139.99
L2	S00°42'54"E	150.00
L3	N43°41'04"E	28.58
L4	S88°05'01"W	119.99
L5	S00°42'54"E	170.00
L6	S88°00'05"W	140.00

MONUMENT AT EAST 1/4 COR. BURIED UNDER ROAD. RE-ESTABLISHED POSITION FROM SWING TIES TO BEARING OBJECTS.

REGISTERED PROFESSIONAL LAND SURVEYOR

Paul W.P. Tomkins
 OREGON
 JULY 26, 1988
 PAUL W.P. TOMKINS
 2360
 renews 6/30/18
 August 8, 2016

	CLIENT: MICHAEL ANDERSON PROJECT NO.: 4450-00		
	SURVEYOR: PWP TOMKINS DATE: 08/04/2016		
	CALC BY: PWPPT	DRAWN BY: PWPPT	SCALE: 1"=100'
	SECTION: NW1/4 S36	TOWNSHIP: 6N	RANGE: 36E
CITY: N/A		COUNTY: UMATILLA SHEET 1 OF 1	

5 N. Colville St., Suite 200
 Walla Walla, WA 99362-1913
 509/956-3026
 306/895-3488
 509/547-5129 fax
 www.hdjg.com