

HORIZONTAL CONTROL DATA

OREGON STATE PLANE, NORTH ZONE (3601)

STA. NAME: 9310

QUARTER SECTION: NE

GEODETTIC COOR: NAD 83(91)

SEC. 21 TWP.5 N,RGE.28E  
UMATILLA CO.ORE.

LAT: 45°54'17.42728" N

DATE SET: JULY ,1993

LONG: 119°18'24.55296" W

SURVEYOR: WALTER L. CASWELL  
PLS 737

SP. COOR: NAD 83(91)

FIRM: EAGLE GPS SURVEY CORP  
13545 NW SCIENCE PARK DR  
PORTLAND, OR. 97229  
(503) 643-1073

N: 818246.515 INT.FT.

E: 8505841.469 INT.FT.

THETA: 0°50'46.270"

TYPE: GPS

SCALE FACTOR: 0.999977197

ORDER: SECOND, CLASS: 1

ELEV: 425.839 US.FT.

ELEV. DATUM: NGVD 29

\*\*\*\*\*  
DIRECTIONS "TO REACH"

FROM THE INTERSECTION OF HWY. 395 (UMATILLA STANDFIELD HWY.) AND  
BENSEL ROAD, TRAVEL NORTHERLY ALONG HWY. 395 0.8 MILE TO A  
CROSSROAD TO THE WEST (JUST SOUTH OF RODEO GROUNDS). TRAVEL WEST  
DOWN SAID ROAD 0.7 MILE TO MONUMENT 70 FEET NORTH OF CENTERLINE  
ROAD.

STATION IS A 5/8" X 30" IRON ROD WITH A YELLOW PLASTIC CAP  
INSCRIBED "BUFORD ASSOC. PLS 1148".

STATION IS 165 FEET EAST OF ROAD GATE AND CATTLE GUARD, AND 70  
FEET NORTH OF CENTERLINE OF ROAD.

METERS X 3.28083333333 = U.S. FEET  
METERS X 3.28083989501 = INTERNATIONAL FT.

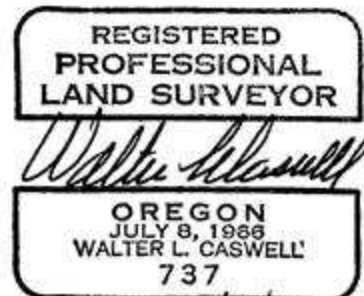

Exp. 12/31/93