

Rd #15

Plat of Road from Delaunts ford

JD

Smylers & Reeds mill
Range 30 E

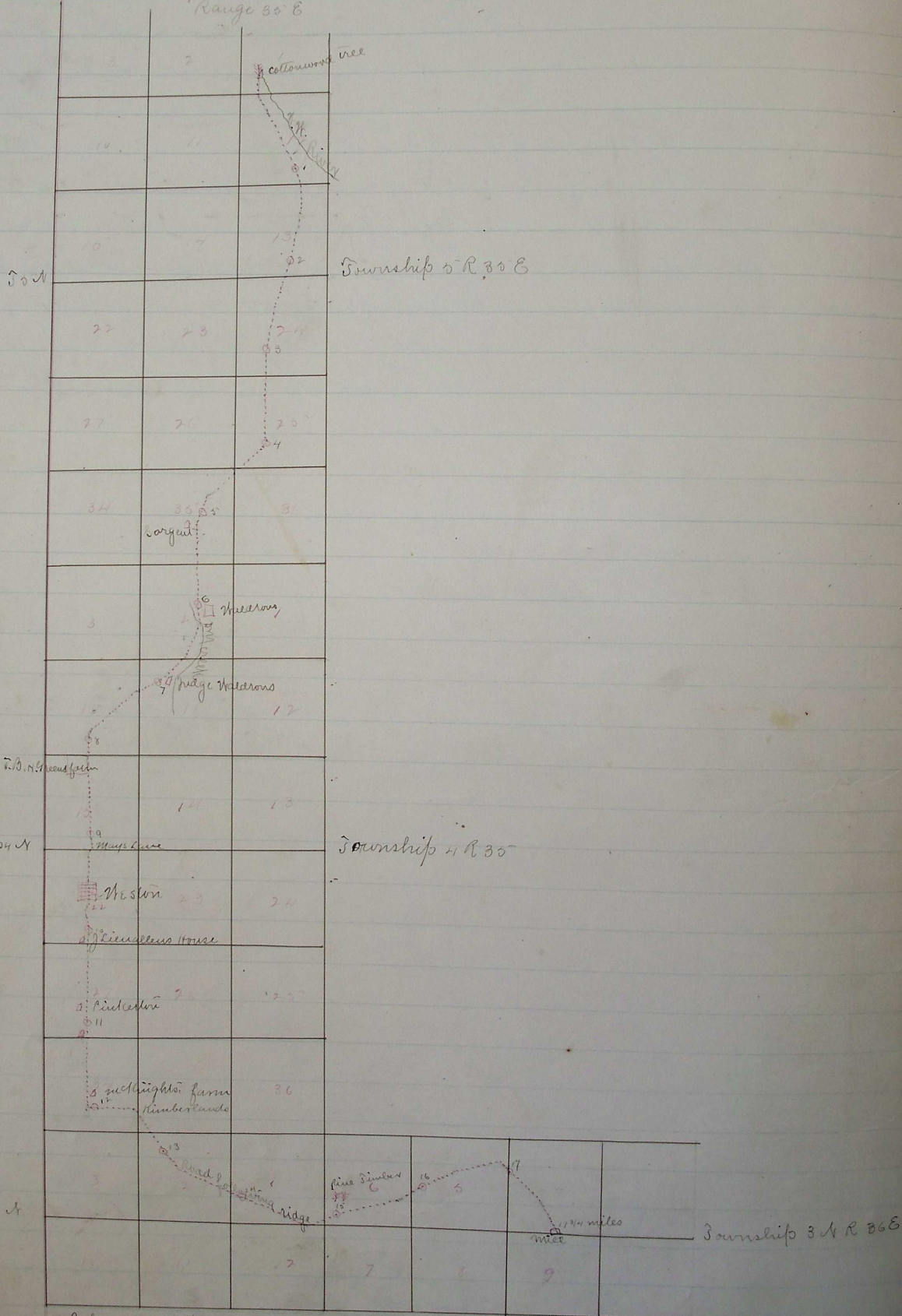

I hereby certify that the above is a correct plat of the road as surveyed by me from Delaunts ford of Walla Walla River to Smylers mill as petition called for, accompanying this is the field notes of the same.

J H Sanner Surveyor

road granted Oct. 21st 1871, See Co. Court Journal, 5th page 105