

Field Notes. (continued)

Rd #35

Station	Bearings	Chains	Meters
65	South	39	
66	East	123	12
67	East	5	126

Remarks

Rd #45

to intersection of Perkins Road.

I certify that the within is a true copy of the field notes of the survey made by me of a road commencing at the cross road on Pine Creek thence up Pine Creek & up the mass Gulch thence to intersect the Co Road running from Weston to Perkins as called for in the petition

J. N. Sharon

Co Surveyor

I certify that the annexed is a true plat of the County Road as surveyed by me commencing at the cross Road on Pine Creek & ending at County road running from Weston to Perkins.

J. N. Sharon
Co Surveyor

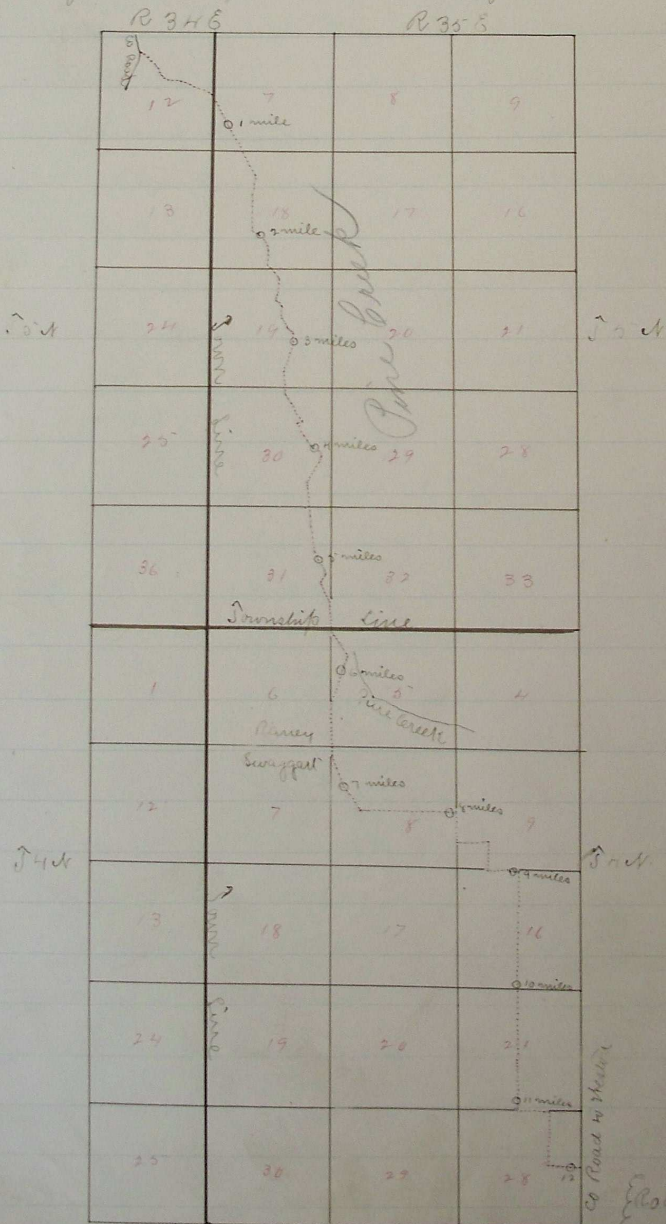

Road granted & located Sept. 10th 1874
See Co. Court Journal p. page 401