

Rd #99

mark

"

"

"

"

"

"

"

"

"

"

"

"

"

"

"

"

"

"

"

"

"

"

"

"

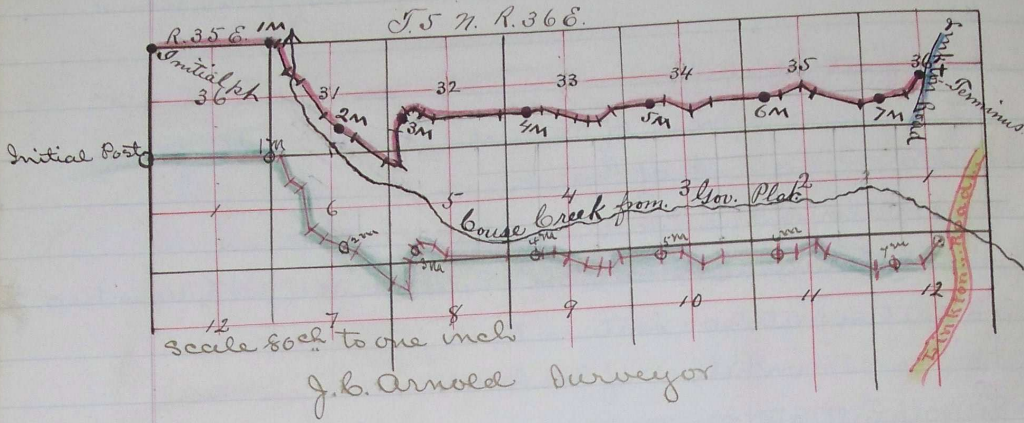

Plat of bounty Road from S W cor of Sec 36
 T. 5 N. R. 35 E. to intersect Linton Road
 Journal T 547
 " " 600
 " E. 64

Note The correct Plat above is marked in red.