

Report of Viewers. Field Notes and Plat of Survey of County Road leading from Cold Spring to Pine Creek. Road No 168

To the Hon County Court for Umatilla County Oregon.

We the undersigned having been appointed by your Hon. body to view out and survey a change in said Road No 168 being at a point 200 yards South of 1/2 mile stake on the East boundary of Sec 7 Tp 5 N. R 33 E. and being on a N. westerly direction to intersect the six mile post.

We met at the time and place appointed and after being qualified according to law by A. C. Coffey County Surveyor, we called to our aid W. W. Caviness and G. B. Clarke as chairman and Benj Stanton as marker, we proceeded to view out and survey said Road as set forth in the Order, we find the proposed road a good practical road and easily opened and much needed.

We would ask that the petition for said road be granted, this 26th day of July 1883.

Viewers { W. W. Caviness
Benj Stanton
Geo B. Clark

No 168

Course commencing at a point 200 yards South of the 1/4 Sec Corner on the East line of Sec 7. Tp 5: N. R. 33 E. of W. M., by planting a post marked R. from which we run N. 40. W N 40 W. 11.00 Angle thence North 47.50 Angle " N 70 E 61.50 " " N 26 E 67.00 Intersect Road at the 6 mile post which we marked with the letter R.
Tp 5. N. R 33 E.

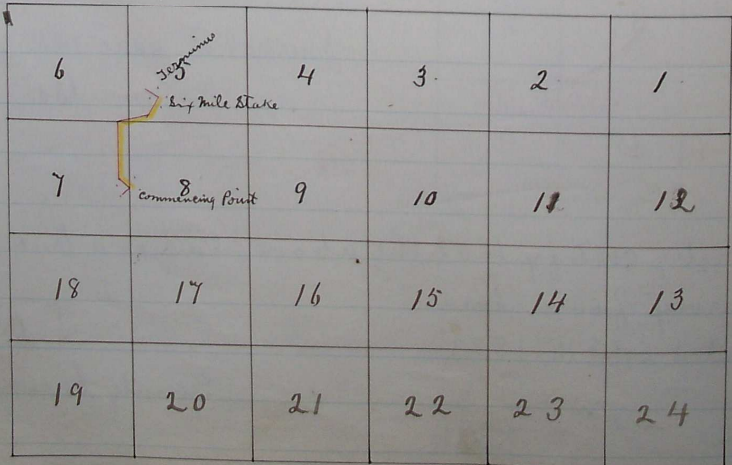

This Road void See Circuit Court Journal "C" page 655

ROAD No
158

I her
and return
this
Journal
" "
Recd
Rep
Comm
Walla
We
survey
1/4 of
W
quall
call
and for
said
that
open
for
th
Rea