

West 80.00 Set Post marked 1 m
 " 2.50 Angle thence
 North 45.00 Angle thence
 West 66.00 Angle "
 North 80.00 Set Post marked 2 m,
 " 61.00 Angle thence
 West 80.00 Set Post marked 3 m.
 " 1.50 Intersect point designated in petition and
 planted a post marked R,

Sp 5. N. R. 35 E of W. M.

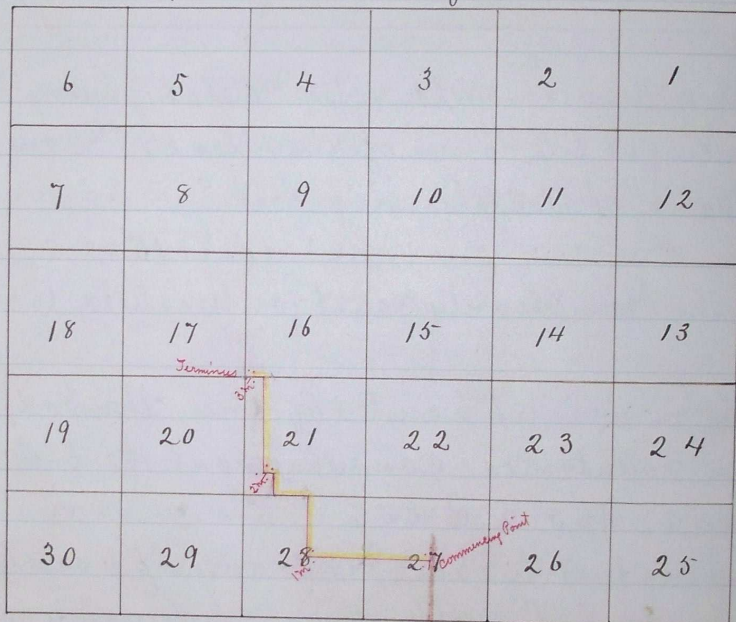

I hereby certify that this above a true and correct survey and Plat of
 the within name and N^o Road

A. L. Coffey, County Surveyor
 Umatilla County, Oregon

Journal F. Page 66767
 " F " 1297130

Recorded October 2nd 1883

J. P. Bushlee
 Clerk