

Sp 1. N. R. 32 E. Initial Point

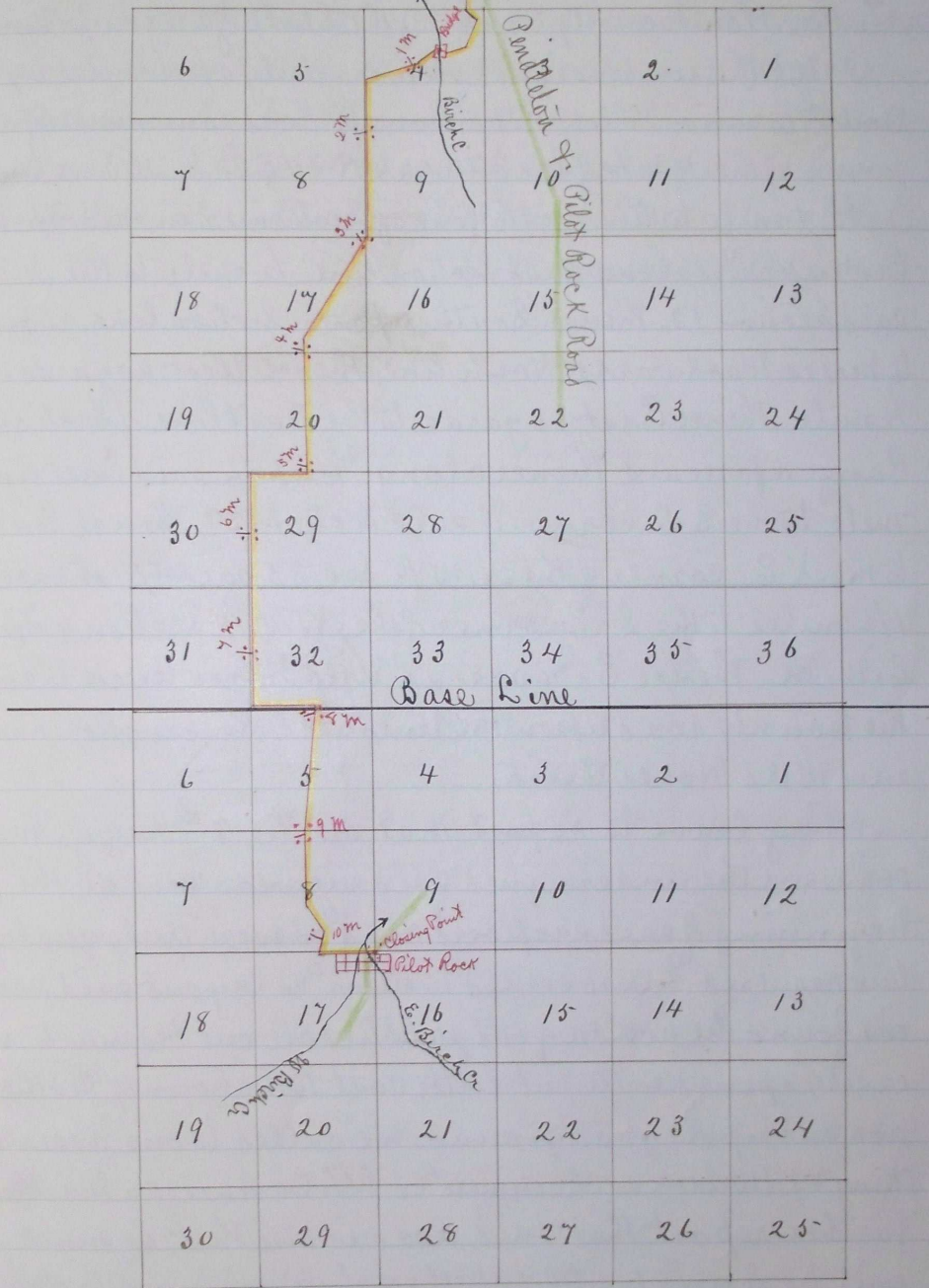

I hereby certify that the within is a true and correct plat and survey of Road No 161. as surveyed by order of the County Court of Umatilla Co. Oregon. This 24th day of August 1883

A. L. Coffey, County Surveyor of Umatilla Co Or

Journal F. Page 74.

" F " 129

Recorded Oct 1st 1883

J. P. Bushee Clerk