

Plat of Road N<sup>o</sup> 195.

N.  
T<sup>p</sup> 5 N. R. 32. E. W. M.

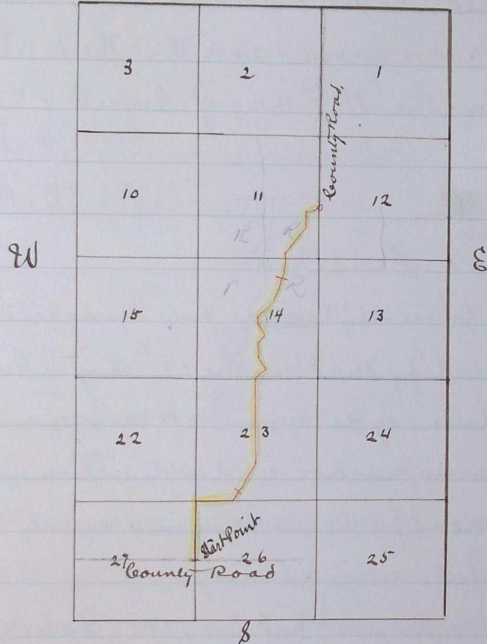

Scale 1 inch to the mile

I hereby certify that this is a true  
 Plat of Road Survey 195:  
 Surveyed this the 18<sup>th</sup> day of August 1884  
 W. W. Coomes  
 Surveyor

Journal J. page 381  
 .. J. .. 452  
 .. J. .. 572

Recorded Sept 15<sup>th</sup> 1884  
 J. P. Bushee  
 Clerk