

Plat of Road No 176.

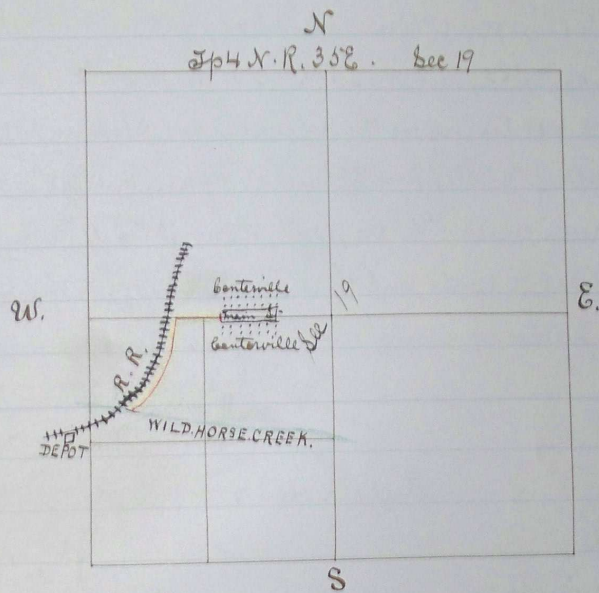

Journal F. page 244
 " F. " 365
 " F. " 455
 " F. " 568

Recorded Sept 15th 1884

J.P. Bushee
Clerk.

I hereby certify that this is a true plat of Road Survey 176. from Centerville Oregon to Wild Horse Creek.

This the 15th day of March 1884

W. W. Caviness
Surveyor.