

# Plat of Road N<sup>o</sup> 210

I hereby certify that the following is a correct plat of  
County Road N<sup>o</sup> 210 for Umatilla County, Oregon.

Jno C. Arnold

Surveyor.

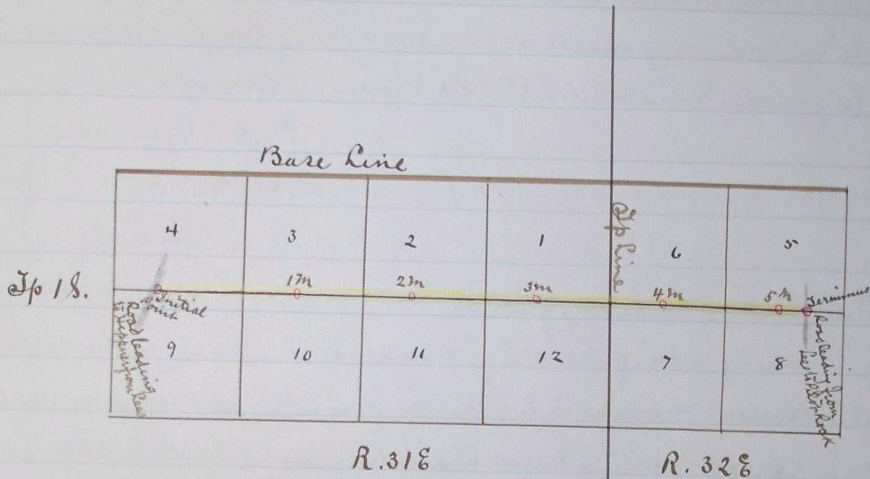

Journal F. page 459

" F. " 571

Recorded Sept 16<sup>th</sup> 1884

J. P. Bushe  
Clerk.