

42.50 Out A on post in wire fence N 78. ^{qu} turn
 North 43.50 Descend
 54.00 Flat
 72.00 Ascend
 73.72 Summit
 80.00 Set 5 mile post 20' east of wire fence
 Continue Course
 2.50 Descend
 11.70 Ravine Course E.
 12.00 Ascend
 17.00 Summit
 34.00 Fence E & W
 40.00 Set terminus 20' E of pt

I hereby certify the foregoing are the correct field notes of Road Survey 284
 Jno C. Arnold, Survr, Umatilla Co. Or.

Plat of Road Survey No 284.

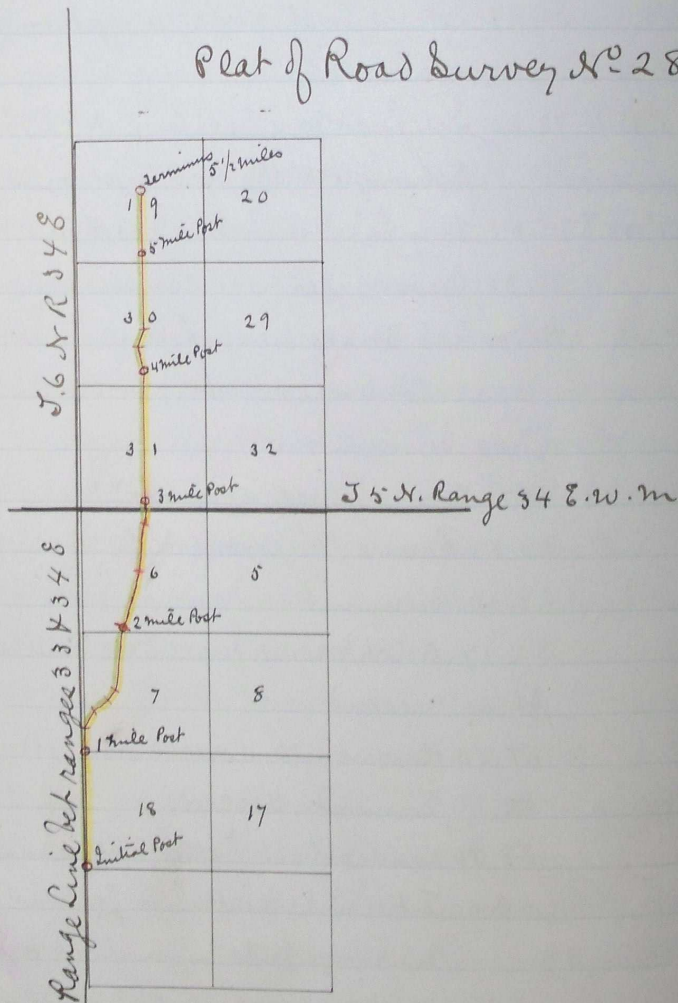

Journal G. page 521.
 " G. " 583

Recorded July 20th 1887

G. A. Hartman
 Clerk

By J. H. Parkes, Deputy

Vault Box No 279.

I hereby certify the foregoing to be a
 correct plat showing Road Survey No 284, for
 Umatilla Co. Oregon.

Jno C. Arnold, County Survr