

S 85° 37' W 2274
 N 70° 48' W 2466 Det angle post on flat E of Pine creek and turn
 S 13° 58' E 3024 " " " in traveled road and turn
 S 9° 32' W 3065 Pine Creek 50 across course NW ascend.
 3273 Det angle post and turn,
 N 81° 43' W 3454 " " " on Summit and turn,
 S 65° 02' W 3860 bor for 1/4 Dec bet Decs 21 & 22 log fence N. & S. Cut A on
 fence at cor and turn on Dec line
 South 5280 Set 4 m P. 20' E of line
 1160 " terminus post in mound.

I hereby certify that the foregoing is a true copy
 of the original notes of the survey of R No 338 for Uua-
 tilla County Or

Jno Arnold Surveyor

Filed July 10-1890
 W.M. Pierce Clerk

I hereby certify the following to be a correct plat
 of the survey of Road No 338 Township 5S Range 32 East
 of Willamette Meridian as made by me July 12-30, 1890

Jno Arnold
 Surveyor for Uuaitilla Co. Or

5 S. 32

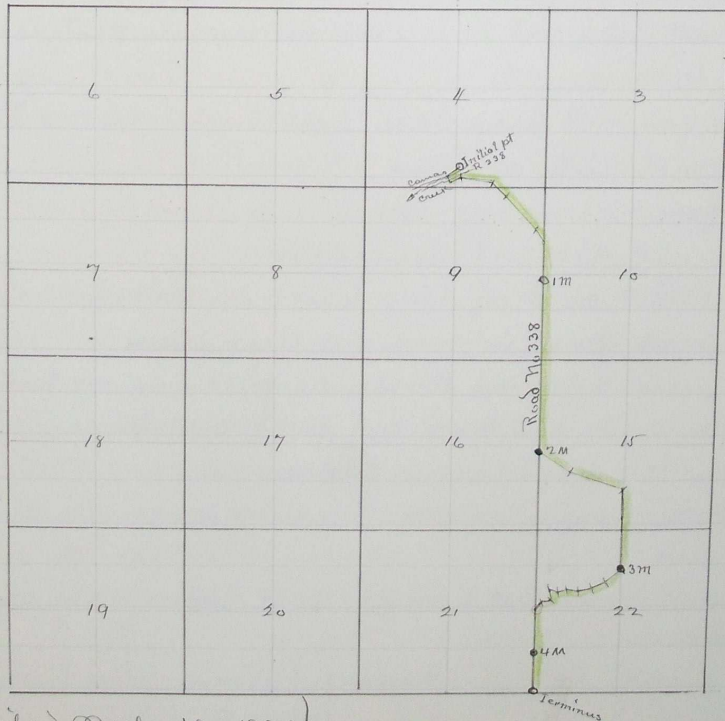

Filed July 10-1890
 W.M. Pierce Clerk

July 16 1890 H 573

ROAD No 338
 Report
 County
 County
 at the st
 ning N
 1/2 of Dec
 ships 4
 East on
 of the U
 line be
 the S & E
 on the l
 50 m
 N & E cor
 Do the st
 Uuaitilla
 viders
 Or wo
 Jno C
 appon
 qualifi
 aid Edg
 were e
 wo view
 as prac
 find the
 outlet
 to the f
 upon S
 lines.
 repair.
 road roa
 Uuaitilla
 day of
 July
 G. Hartman
 Filed
 3 m
 Bond