

B. Reicks  
and prof  
assistant  
ided.

14 7 5 NR  
Ascend, Var 22° E.

con

on line

ne.

see line,  
to N. E. of School  
ft. E on N

t notes of

### Plat of Road No. 344

TOWNSHIP 5 N RANGE 32 E W. M.

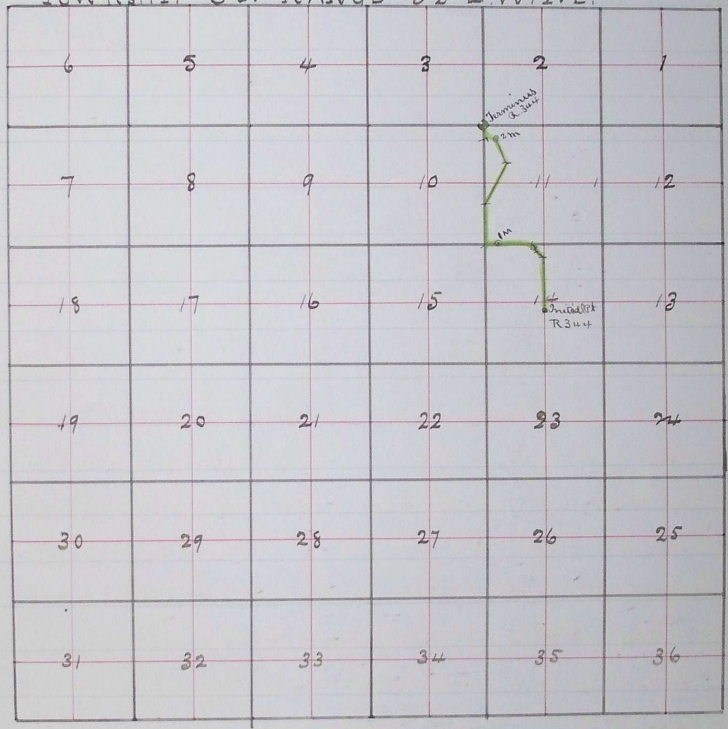

I hereby certify that the foregoing plat of  
Road survey No 344 for Umatilla County  
Oregon is correct.

Jno. G. Arnold. Surveyor

Filed Aug 19 1890  
W. M. Pierce Clerk. Nov 12 1890 P 626