

Plat of Road No 247

I hereby certify that the following is a correct plat of the No 247 Road Survey as made by me Friday April 3^d 1891.

J. W. Lawry
Surveyor

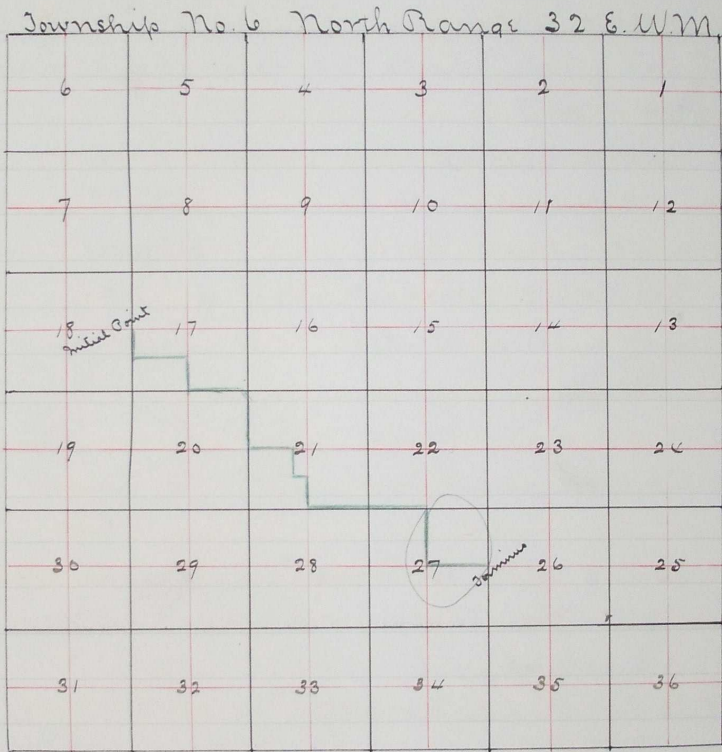

Filed May 5th 1891

W. M. Dine Clerk. Nov. 11 1890 FO 621-647-698-737

ROAD NO
358

Re
of P
com
east
24
was
com
mer

Re
So

mat
wa
Wee
as C
ass
We
said
We
and
that
a C
Sat

File
W.

Fi

In
Holl
uid
and
die
I a
33
250
2350
2640