

Plot of Road Survey No 383

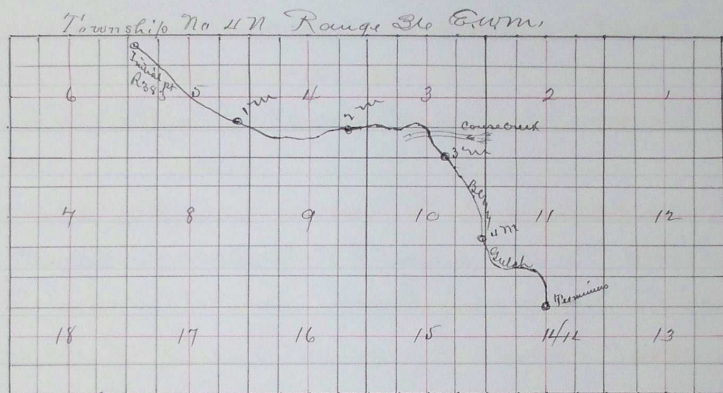

The original surveys in this part of the Township have been poorly made and this may throw the platting out of proper connection with some of the lines of original surveying. The said road 383 however is well marked with angle and mile stakes and from its beginning at the mouth of Gordon Gulch on N side of horse creek, the road is located upon the old traveled road north of horse creek until it reaches Berry Gulch coming in from the SE, thence the road crosses horse Creek and up Berry Gulch whence it can not be mistaken even were there no other marks, for the great cause of all things has so build up the ground in the vicinity of Road 383 that, once in it, it would be a very difficult affair indeed to get out of it

I hereby certify that the foregoing is as correct a plot of Road Survey No 383 as the average of common mortality can make

Jno L. Arnold 1st Suror

Filed March 12. 1892

Wm. Pierce Clerk

192