

Plat of Road No 419

I hereby certify the following to be a correct plat of the survey of road 419 Township 3. N Range 19 East of Williamette Meridian as made by me, Apr 20 to 23^d 1893

Jno. C. Arnold
Surveyor for Umatilla County Oregon

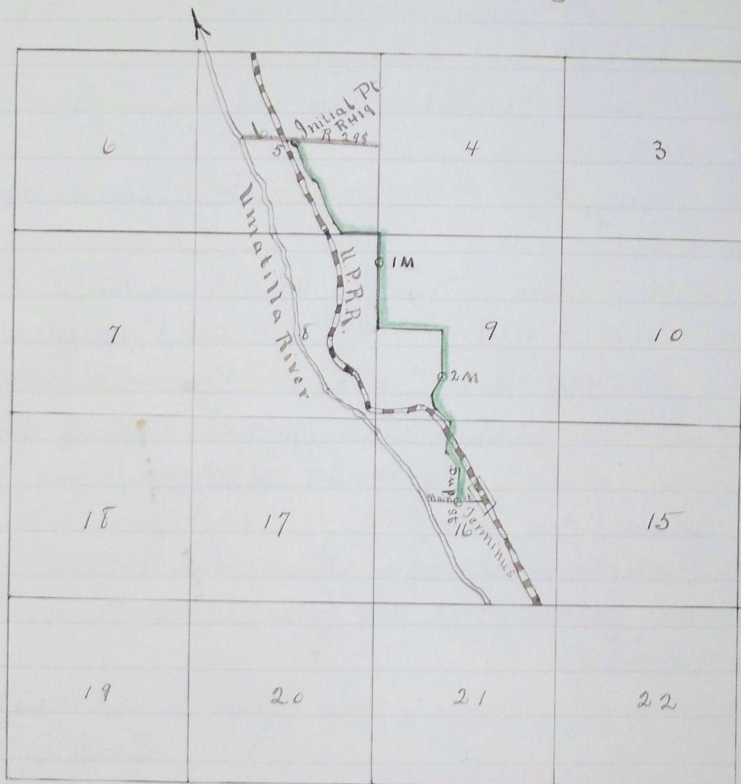

Filed May 3. 1893
W.M. Pincus
Clerk

11 489