



COMMISSIONERS
M. K. McIVER, CHAIRMAN
PORTLAND

Glenn L. Jackson

~~ROBERT B. CHESSMAN~~, MEMBER
~~ASTORIA~~

Medford

KENNETH N. FRIDLEY, MEMBER
WASCO

FLOYD QUERY, SECRETARY
SALEM

W. C. WILLIAMS
STATE HIGHWAY ENGINEER
FORREST COOPER
DEPUTY STATE HWY. ENGR.
LEONARD I. LINDAS
CHIEF COUNSEL

STATE OF OREGON
STATE HIGHWAY DEPARTMENT
SALEM

May 7, 1959

County Court of Umatilla County
Court House
Pendleton, Oregon

Gentlemen:

We are enclosing for the records and files of Umatilla County a fully executed copy of an Abandonment Atreement with Umatilla County covering the Weston-Milton-Freewater Section of the Oregon-Washington Highway.

Very truly yours

OREGON STATE HIGHWAY COMMISSION

Floyd Query

Secretary

rn
Enc.

AGREEMENT

THIS AGREEMENT, made and entered into this 4th day of May, 1959, by and between the STATE OF OREGON, by and through its State Highway Commission, hereinafter called "State"; and UMATILLA COUNTY, a political subdivision of the State of Oregon, by and through its County Court, hereinafter called "County";

W I T N E S S E T H:

RECITALS:

1. For the purpose of furthering the development of a highway system adapted in all particulars to the needs of the people of the State of Oregon, the State has relocated and shall construct a section of the Oregon-Washington Highway, State Primary Highway No. 8, known as the North Unit, Weston-Milton-Freewater Section in Umatilla County, the northerly terminus of which is at Highway Engineer's Center Line Station 31+00 on the former highway and the southerly terminus of which is at relocated Highway Engineer's Center Line Station 1186+50.

2. By the authority granted in ORS 366.300, State is empowered to enter into an agreement with County for the disposition of portions or units of any state highway that may be eliminated from the original route by the relocation and realignment of said highway.

3. The construction of the said relocated portion of the Oregon-Washington Highway, State Primary Highway No. 8, shall make possible the elimination by State of a portion of the former route hereinafter described as Unit "A". It is the purpose and plan of the parties hereto that Unit "A" shall pass to County as part of the county road system as long as needed for the service of persons living thereon or communities served thereby.

4. Unit "A" of the former Oregon-Washington Highway which is to be eliminated is shown colored in red on the map attached hereto marked Exhibit "A" and by this reference made a part hereof. The description of Unit "A" is as follows:

Unit "A":

All the land situated within the right of way boundaries of the Oregon-Washington Highway as formerly routed beginning at the northwesterly right of way boundary line opposite relocated Highway Engineer's Center Line Station 1191+00 of said highway as relocated in the northwest quarter of the southeast quarter (NW $\frac{1}{4}$ SE $\frac{1}{4}$), Section 2, Township 4 North, Range 35 East, W.M.; thence northerly via said highway as formerly

routed to the westerly right of way boundary line opposite relocated Highway Engineer's Center Line Station 1420+00 of said relocated highway in the southeast quarter of the northwest quarter (SE $\frac{1}{4}$ NW $\frac{1}{4}$), Section 13, Township 5 North, Range 35 East, W.M.

NOW, THEREFORE, the premises being in general as stated in the foregoing recitals, it is agreed by and between the parties hereto as follows:

THINGS TO BE DONE BY STATE:

1. After the North Unit, Weston-Milton-Freewater Section of the relocated Oregon-Washington Highway has been completed and opened to public travel State, by resolution, shall formally eliminate said Unit "A" as part of the Oregon-Washington Highway and the state highway system; and all right, title and interest which State has in the right of way of Unit "A" shall thereupon pass to and vest in County.

2. State shall place Unit "A" in serviceable condition before being eliminated and turned over to County.

3. State shall retain that portion of the right of way of the former North Unit, Weston-Milton-Freewater Section of the Oregon-Washington Highway and that real property acquired by State for highway right of way and other public purposes which is shown colored in green on Exhibit "A" attached hereto.

THINGS TO BE DONE BY COUNTY:

1. County, by execution of this agreement, does hereby consent to and approve the provisions of paragraphs 1 through 3 under THINGS TO BE DONE BY STATE.

2. County agrees to accept all right, title and interest of State in Unit "A" and shall accept jurisdiction and control over said Unit "A" and shall maintain it as part of the county road system as long as needed for the service of persons living thereon or communities served thereby.

3. County shall execute this agreement during a duly authorized session of its County Court.

IN WITNESS WHEREOF, the parties hereto have subscribed their

names and affixed their seals as of the day and year first above written.

ATTEST:

Floyd Query
Secretary

APPROVED:

W. A. Leonard
Assistant State Highway Engineer

APPROVED AS TO FORM:

L. H. Hudas
Chief Counsel

STATE OF OREGON, by and through
its State Highway Commission

By W. M. Day
Chairman

By J. M. Bradley
Commissioner

By Edwin Jackson
Commissioner

UMATILLA COUNTY, by and through
its County Court

By D. D. Cook
County Judge

By H. H. Davis
County Commissioner

By Cecil B. Slanin
County Commissioner

ATTEST:

Jean M. Bell
County Clerk

LVN:mmb
2/9/59

NORTH UNIT WESTON-MILTON-FREEWATER SECTION

OREGON-WASHINGTON HIGHWAY

UMATILLA COUNTY

JANUARY, 1959

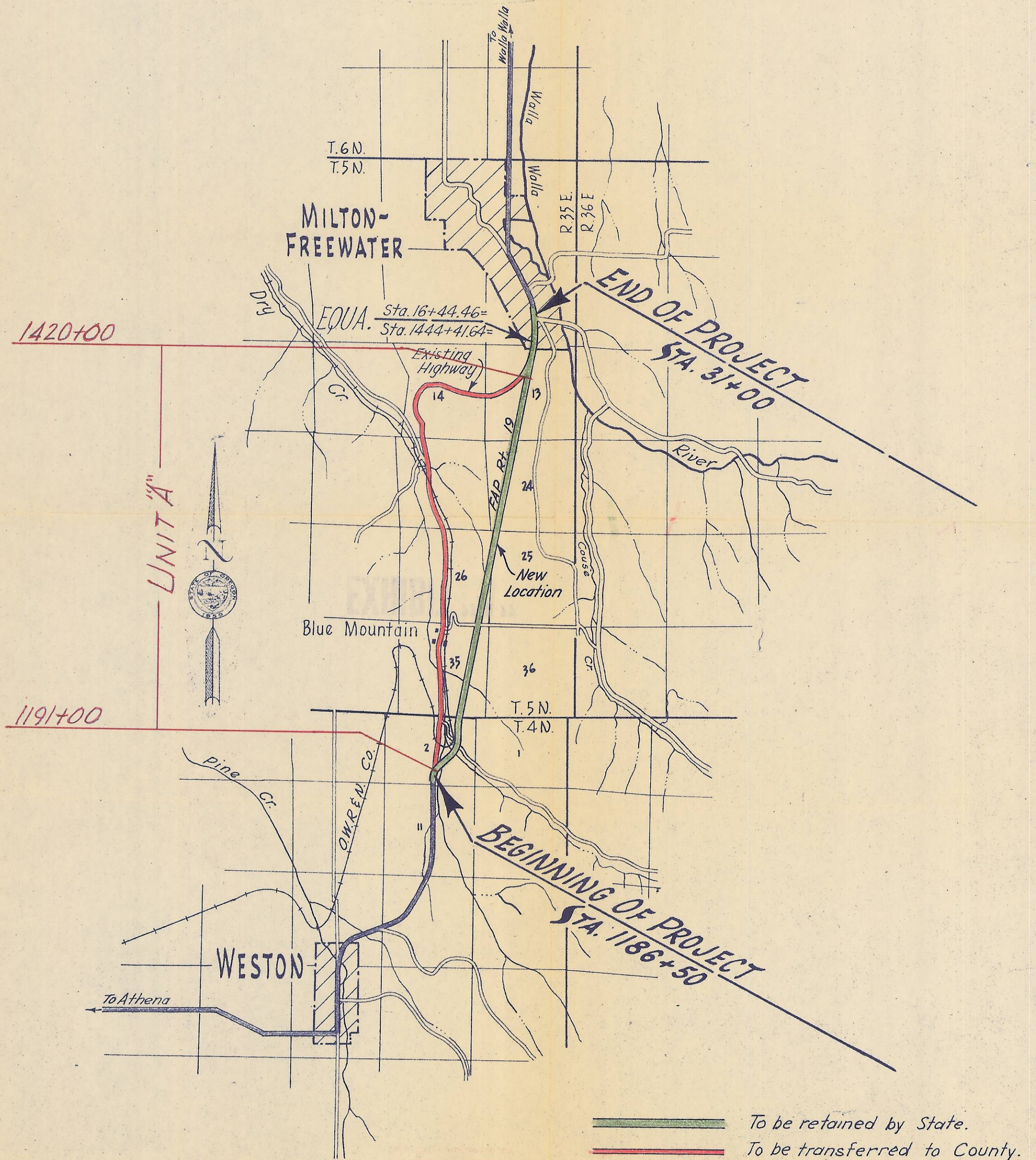

EXHIBIT "A"

Sketch Map

Scale 0 1 2 Miles