

- Walker Rd 1231
- Westland Rd 1215WE
- 1<sup>st</sup> Pl (N) 1275-1
- 1<sup>st</sup> St (S) 1245-1
- 2nd St (NE) 1227
- 4th St (SE) 1193
- 9th St (SE) 1197
- 10th St (NE & SE) 1219
- 10th St (SW) 1297
- 11th St (NW) 1247
- 17th St (SW) 1189
- 23rd St (SW) 1238-23

**ROAD 851  
WIDTH = 40'**

R27

R28

?

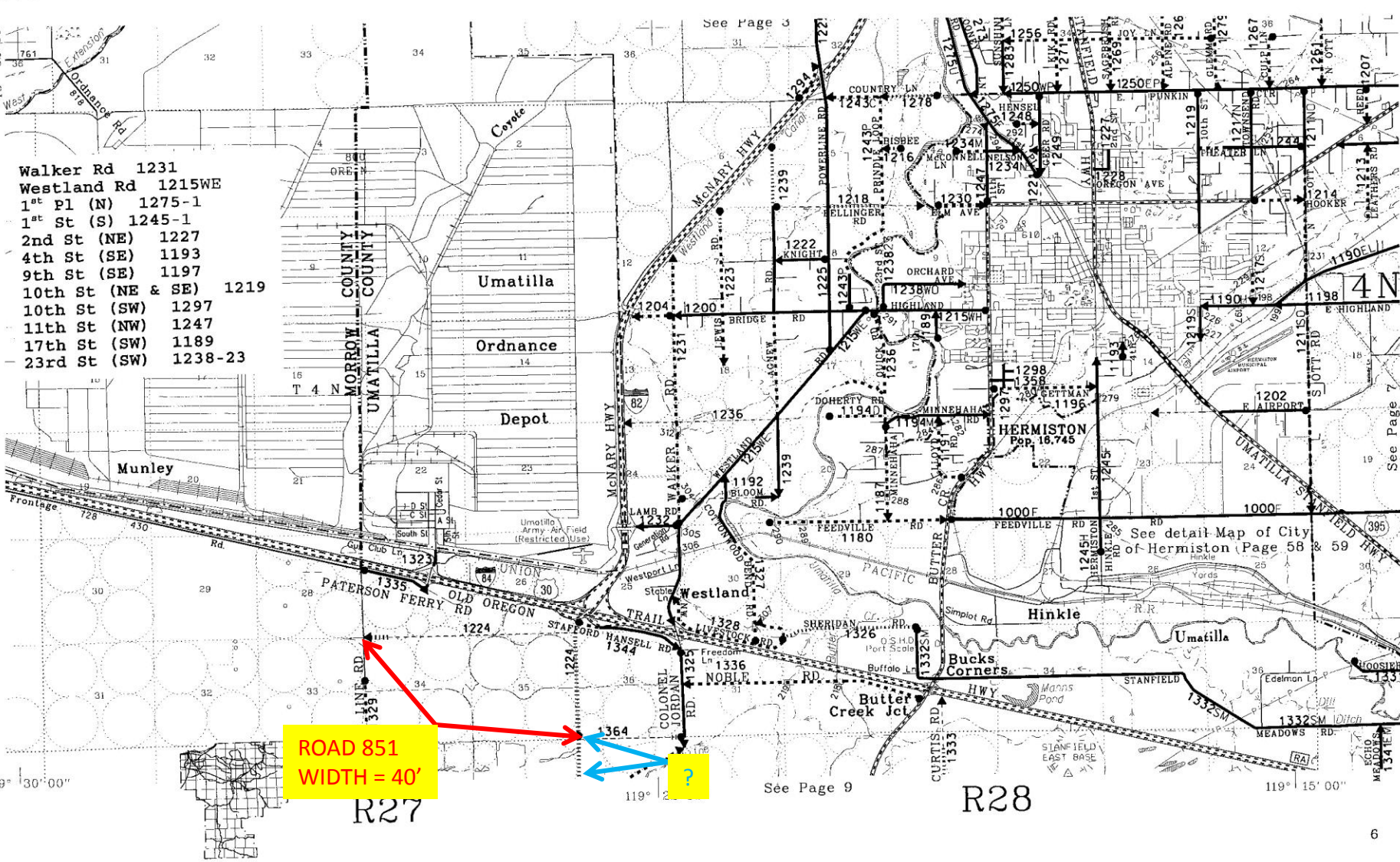

43° 52' 30"  
19° 30' 00"

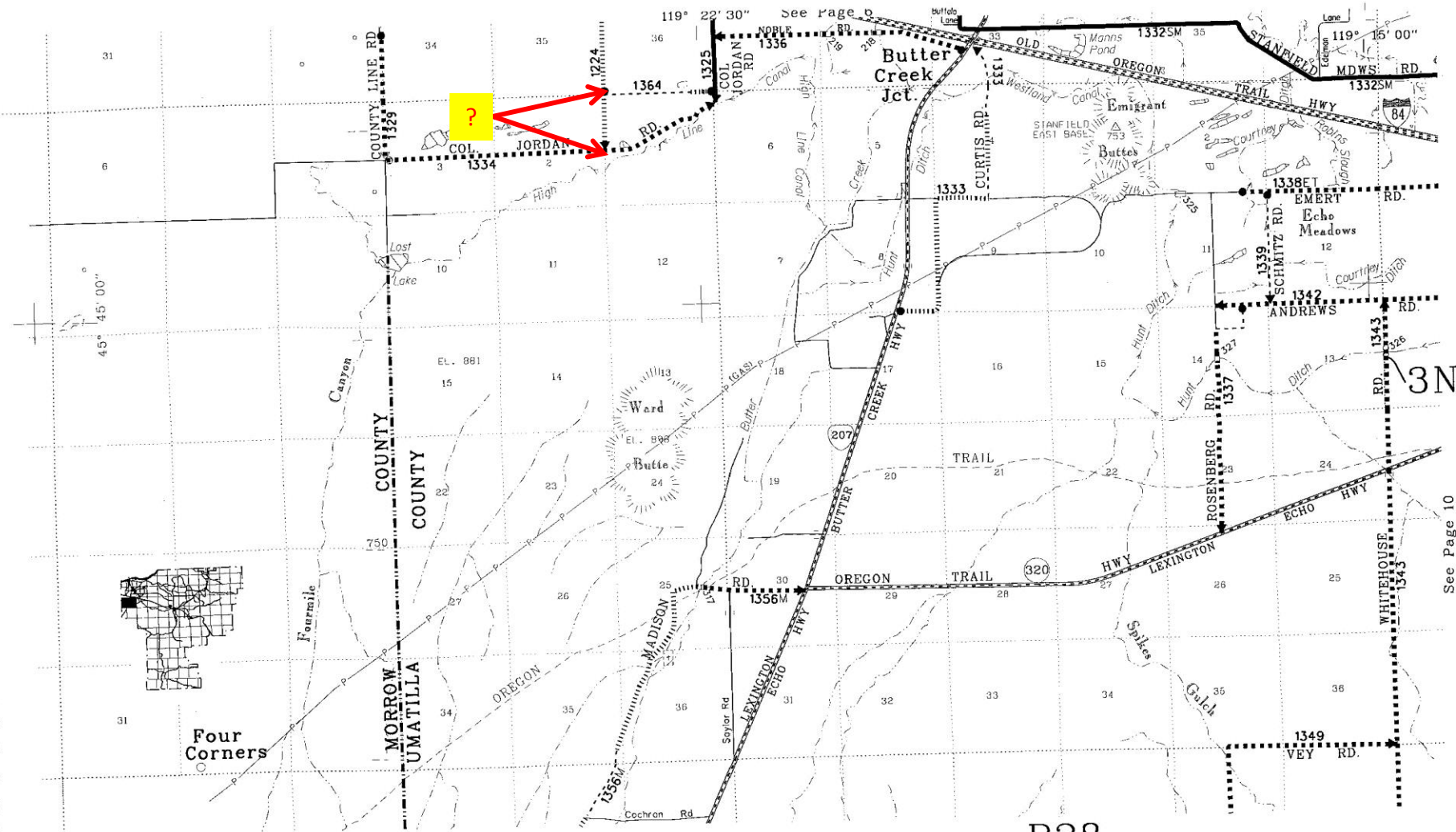

119° 22' 30" See Page 9

119° 16' 00"

45° 45' 00"

R27

See Page 12

R28

9

See Page 10

3N



Four Corners

MORROW COUNTY  
UMATILLA COUNTY

Ward Butte  
EL. 898

Butter Creek Jct.

EMERT  
Echo Meadows

SCHMITZ RD.  
ANDREWS

STANFIELD  
EAST BASIN

ROSENBERG  
LEXINGTON

ECHO HWY

WHITEHOUSE RD.

VEY RD.

COUNTY LINE RD  
1329

JORDAN RD  
1334

JORDAN RD  
1325

JORDAN RD  
1336

CURTIS RD  
1333

STANFIELD RD  
1332SM

EMERT RD.  
1338ET

SCHMITZ RD.  
1339

ROSENBERG RD.  
1327

1337

1343

1345

1349

1343

1343

1343

1343