

BARGAIN AND SALE DEED

329250

KNOW ALL MEN BY THESE PRESENTS, That Harvey I. Trout and Veda L.

Trout, husband and wife, hereinafter called grantors, do hereby grant, bargain sell and convey unto the County of Umatilla hereinafter called grantee, and unto grantee's heirs, successors and assigns, all of that certain real property with the tenements, hereditaments and appurtenances thereunto belonging or in anywise appertaining, situated in the County of Umatilla, State of Oregon, described as follows, to-wit:

Beginning at Engineer's center line station 15+80.23, said station being 442.33 feet south and 35.83 feet west of the northwest corner of said SE $\frac{1}{4}$  SW $\frac{1}{4}$ , Section 17, T. 5N., R 28 E.W.M.; thence on (a=5.0) Spiral curve right (the long chord of which bears S4 degrees 46' 45" E.) 240.00 feet; thence S 0 degrees 01' 15" W, 419.77 feet to Engineer's center line station 20+00.00. The west line of the said SE $\frac{1}{4}$  of the said SW $\frac{1}{4}$  intersects the east right of way line approximately at station 16+40 and the said parcel is bounded by the Ditch right of way on the south end approximately at Station 18+50.

The parcel of land to which this description applies contains 0.039 acres, of which 0.082 acres lie within the existing right of way, title to which hereby is acknowledged to be in the public right of way.

The above parcel of land lying in the SE $\frac{1}{4}$  of SW $\frac{1}{4}$ , Section 17, T.5N., R. 28 EWM, Umatilla County, Oregon, is that portion of said property included in a strip of land 50 feet in width, 25 feet on each side of the center line of the POWER LINE ROAD #754, County highway as said highway has been relocated, which center line has been described above.

To Have and to Hold the same unto the said grantee and grantee's heirs, successors and assigns forever. The consideration for this deed is less than None Dollars.

Witness Grantor's hand this 15 day of May 1971.

\_\_\_\_\_  
\_\_\_\_\_  
Harvey I. Trout  
Veda L. Trout  
Veda L. Trout

STATE OF OREGON  
County of Umatilla ss.

Personally appeared the above named Harvey I. Trout and Veda L. Trout husband and wife, and acknowledged the foregoing instrument to be their voluntary act and deed.

Before me: [Signature]  
Notary Public for Oregon  
My Commission expires Sept. 6, 1971

SEAL



PARCEL NO. 2

A parcel of land lying in the SE $\frac{1}{4}$  of SW $\frac{1}{4}$ , Section 17, T.5N., R. 28E., W.M., Umatilla County, Oregon. The said parcel being that portion of said property included in a strip of land 50 feet in width, 25 feet on each side of the center line of the POWER LINE ROAD #754, County highway as said highway has been relocated, which center line is described as follows:

Beginning at Engineer's center line station 15+80.23, said station being 442.33 feet south and 35.83 feet west of the northwest corner of said SE $\frac{1}{4}$  SW $\frac{1}{4}$ , Section 17, T. 5N., R. 28 E. W.M.; THENCE on (a=5.0) Spiral curve right (the long chord of which bears S1 $\frac{1}{2}$ °46'15"E.) 240.00 feet; THENCE S 0°01'15"W. 419.77 feet to Engineer's center line station 20+00.00. The west line of the said SE $\frac{1}{4}$  SW $\frac{1}{4}$  intersects the east right of way line approximately at station 16+40 and the said parcel is bounded by the ditch right of way on the south end approx. 632. 18+50. The parcel of land to which this description applies contains 0.039 acres, of which 0.082 acres lie within the existing right of way, title to which hereby is acknowledged to be in public right of way.

HARVEY TROUT & VEDA L. TROUT  
TL-1100; Bk. 251 Pg. 194  
SE $\frac{1}{4}$  SW $\frac{1}{4}$ , Sec. 17, T. 5N., R. 28 E. W.M.

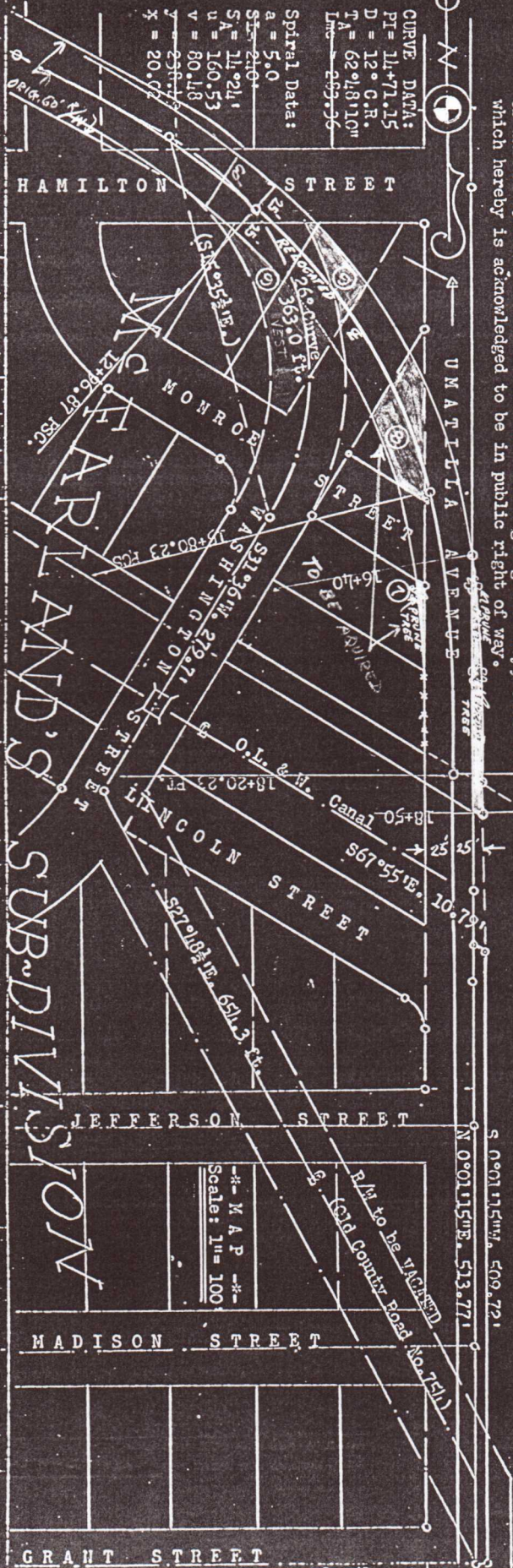

CURVE DATA:  
PI = 14+71.15  
D = 12° C.R.  
TA = 62°48'10"  
Lmc = 259.76

Spiral Data:  
a = 5.0  
S $\frac{1}{2}$  = 219  
S $\frac{1}{4}$  = 11°24'  
u = 160.53  
v = 80.18  
x = 20.02

M.A.P.  
Scale: 1" = 100'

Filed for record 11/11 - 8, 1971 at 10:54 A.M.  
JESSIE M. BELL County Clerk