

45° 52' 30"
West
Ordnanor Rd
Extension
816

- Walker Rd 1231
- Westland Rd 1215WE
- 1st Pl (N) 1275-1
- 1st St (S) 1245-1
- 2nd St (NE) 1227
- 4th St (SE) 1193
- 9th St (SE) 1197
- 10th St (NE & SE) 1219
- 10th St (SW) 1297
- 11th St (NW) 1247
- 17th St (SW) 1189
- 23rd St (SW) 1238-23

See Page 3

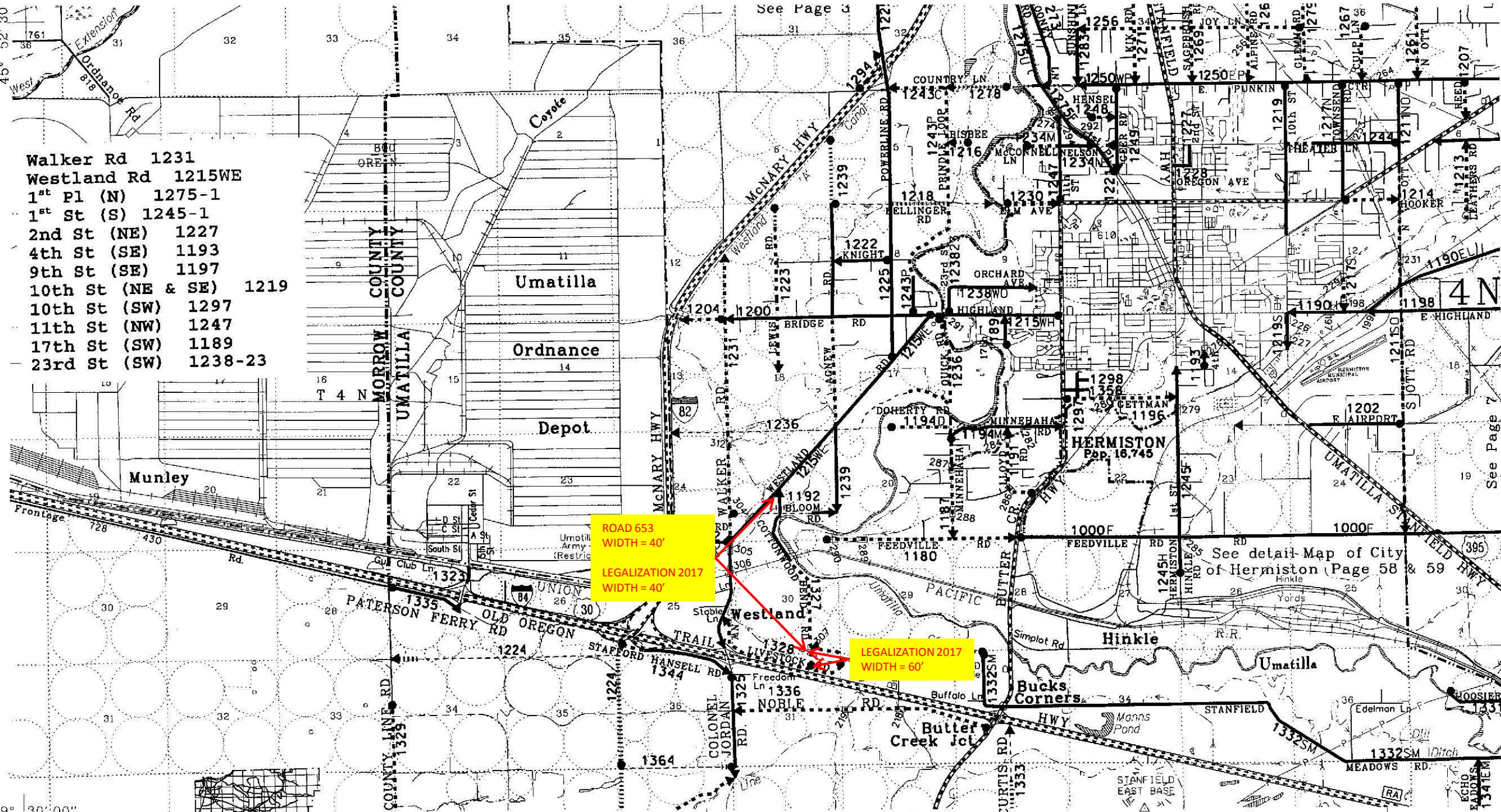

119° 30' 00"

R27

119° 22' 30"

See Page 9

R28

119° 15' 00"

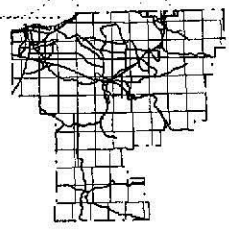

See detail Map of City of Hermiston (Page 58 & 59)

See Page 7