

ROAD 375
WIDTH = 60'

ROAD 172
WIDTH = 60'

ROAD 697
WIDTH = 40'

R27

See Page 12

R28

See Page 10

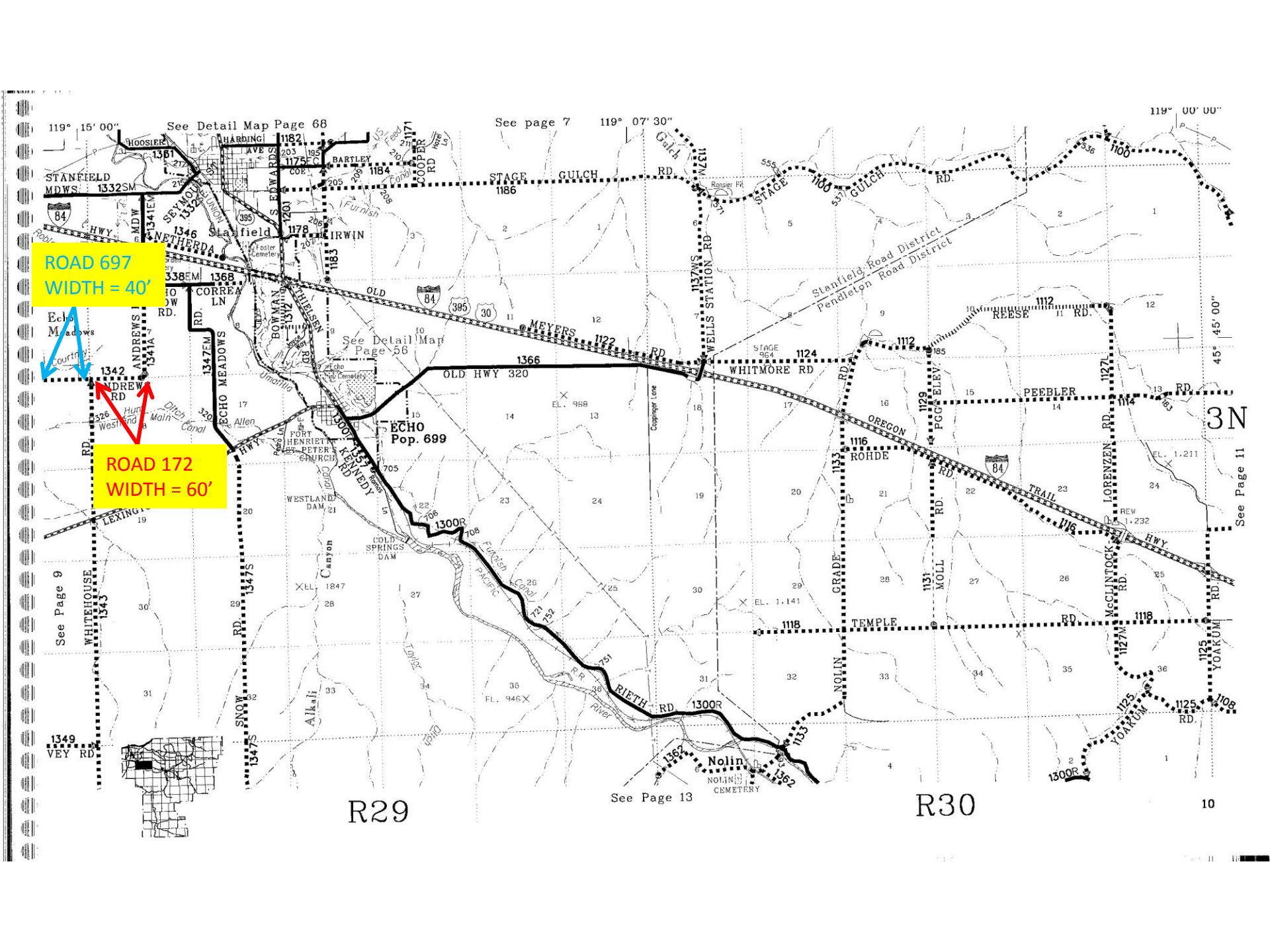

ROAD 697
WIDTH = 40'

ROAD 172
WIDTH = 60'

R29

R30

10

3N
See Page 11

See Page 13

See Page 9

See Detail Map Page 68

See page 7

See Detail Map Page 58

ECHO
Pop. 699

Nolin
CEMETERY

