

# RAILROAD ADDITION TO UMATILLA JUNCTION

## UMATILLA CO. OREGON.

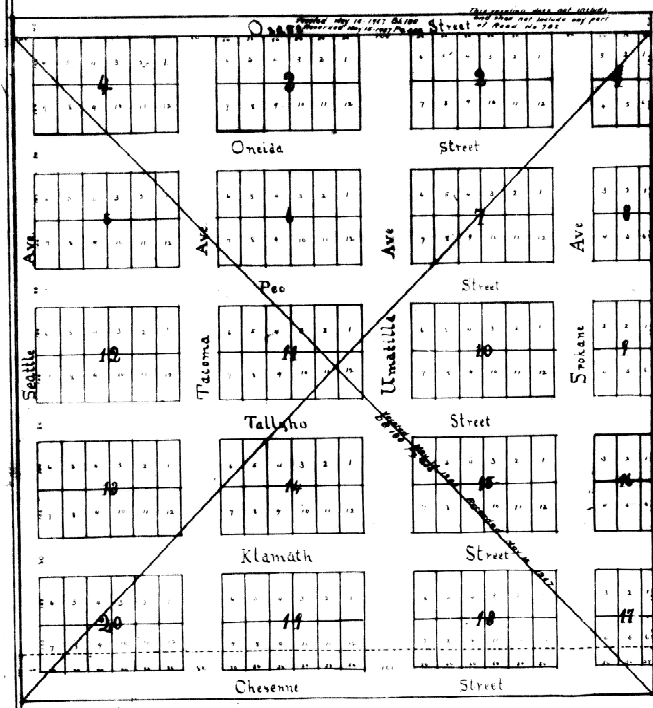

**Description**

Rail Road Addition to Umatilla Junction consists of all the lots of the block and a strip 100 ft wide of the north side of the block of the block of lots 10 20 30 40 50 60 70 80 90 100 and the streets are all 60 ft wide except Umatilla Ave which is 100 ft.

**Dedication**

Know all men by these presents, that the streets in Rail Road Addition to Umatilla Junction as shown in this Plot are hereby dedicated without reservation of any kind to public use.

W. Eugene  
Moses W. Hill  
J. B. Beckwith

J. M. G. Galloway  
Orin Galloway  
Ellen M. Galloway

**Acknowledgment**

Shali & Co. Co. On the fourth day of May 1891, before me the undersigned a Notary Public, in and for said County and State appeared J. M. Galloway, Orin Galloway and Ellen M. Galloway, whose names are subscribed to the foregoing Dedication, personally known to me to be the same persons described in and who executed the said Dedication, freely and voluntarily for the purpose herein stated and in presence of Ellen M. Galloway and of said Shali & Co. being an authorized agent by an instrument and apart from her and husband acknowledged to me that she executed the same freely and voluntarily.

In testimony whereof I have hereunto set my hand and official seal this 4th day of May, 1891.

J. C. Galloway  
Notary Public for Oregon

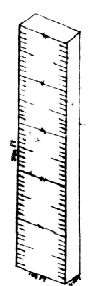

Filed May 9<sup>th</sup> 1891.  
W. M. Pierce Clerk