

T2N, R.33E, W.M.

MISSION JUNCTION INTERCHANGE

For Profiles See Sheets 7A & 7B
For Entrance & Exit Ramp Details
See Drq. Nos. 2092 & 2093

WEST UNIT				SHEET
PENDLETON-EMIGRANT HILL SECTION				7
OLD OREGON TRAIL HIGHWAY				
UMATILLA COUNTY				
FED. ROAD	STATE	PROJECT	FISCAL	TOTAL
D. No.		NUMBER	YEAR	SHEETS
8	OREGON	180N-643213		57

Revised 3-20-70 Corrected Pavement Dimensions
to 12'; Sta. M'6+00 ± & M'22+00 ±

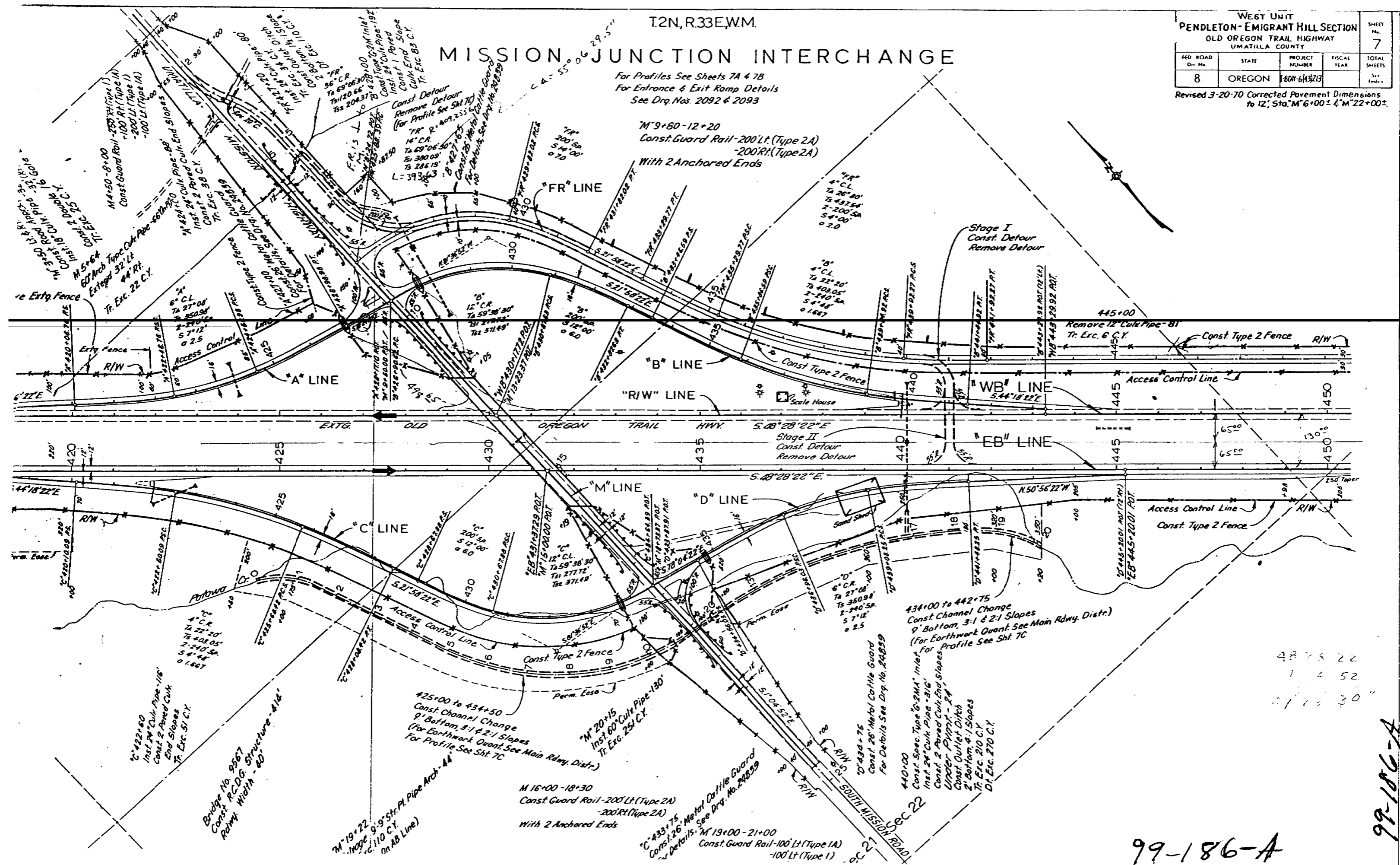

4875 22
1 4 52
5173 30

99-186-A

99-186-A