

Q-816-AX

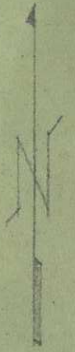
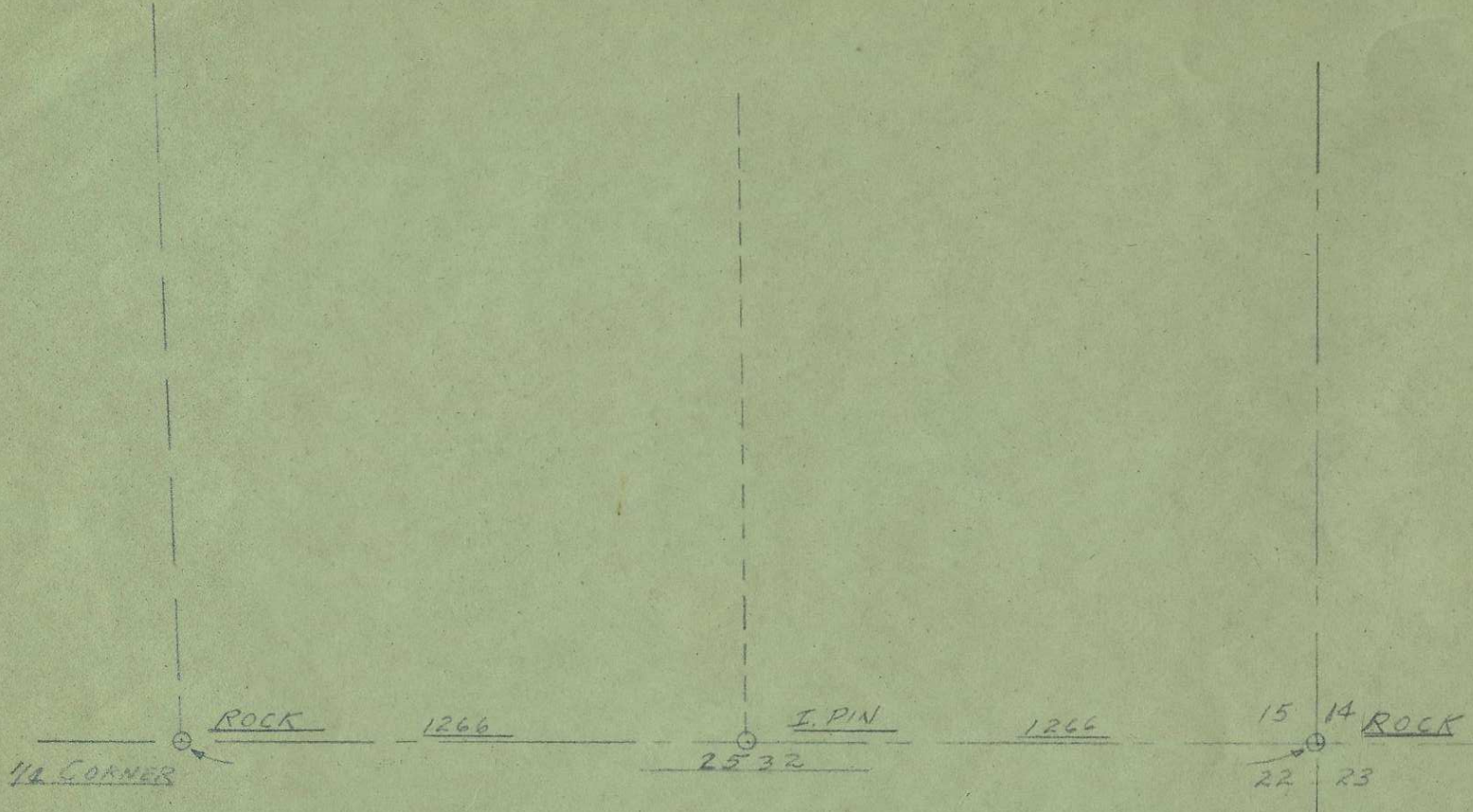

SCALE 1" = 400'

10000

C. H. Storms & Associates

CONSULTING ENGINEERS — ARCHITECTS

324 SECOND AVE. SO. TELEPHONE 4170 WALLA WALLA, WASH.

- Mechanical
- Structural
- Hydraulic
- Sanitary
- Designs
- Land Surveys
- House Plans
- Blue Prints
- Estimates

A SURVEY
FOR
PETE KESSLER
SFG. 15-6N-34E

Date 8/2/51
 Drawn By G.M.N.
 Checked By G.M.N.

1268

SHEET 1 OF 1

City Planning
Supervision
Valuation
Surveying
Reports
Designs

C. H. Storms & Associates

CONSULTING ENGINEERS

REGISTERED WASHINGTON, OREGON

C. H. STORMS
Phone 4692-W
G. M. NEWBILL
Phone 2982-M
GEO. LAUBACK
B. F. CHAPMAN
J. O. BICKFORD, Jr.
E. BUCKNER

TELEPHONE 4170
304 Denny Building
WALLA WALLA, WASH.

FILE

1268

6/20/51

Field Notes
Survey in Sec. 15-6N.-34E.
Owner Pete Kessler

Having found the two rocks which mark the Southeast corner and the South Quarter corner respectively of Section 15 Township 6 North Range 34 East, I ran on a true line between these rocks and at the mid-point I set an 5/8 inch iron pin for the 1/16 corner as shown on the accompanying plat.

G.M. Newbill
G.M. Newbill

Lic. No. 255