

T 6 N R 35 E M
T 5 N R 35 E M.

Found See Corr. 8-14-57.
By R. Thompson.
8x8 Rock Buried 10"
Below Rd Surface with
+ Chiseled on top
(See spike in photo directly
over + on Rock.)

Barrett Grain
Elevator

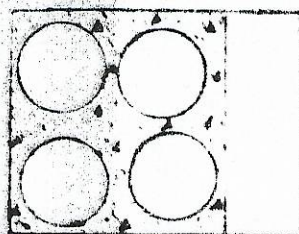

Hubb's Tank
#2234719

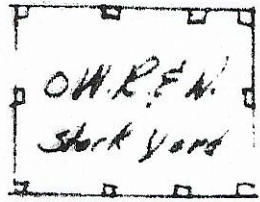

P 217492⁰⁶

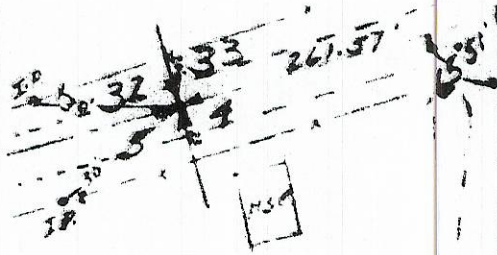
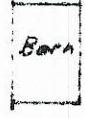

Umatilla Co. Road Dept.

1043