

# RECORD OF SURVEY

FEBRUARY, 1999.

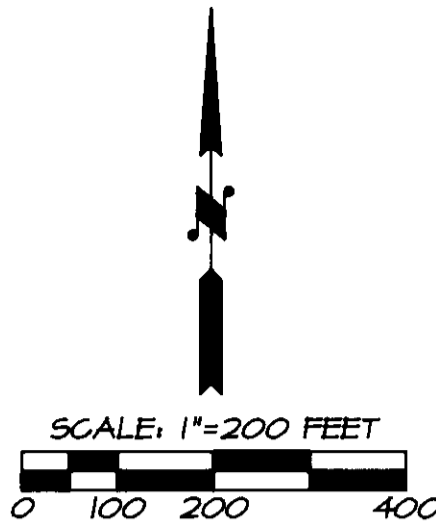

BASIS OF BEARING: LINE BETWEEN MONUMENTS FOUND AT THE SOUTHEAST CORNER AND EAST 1/4 CORNER OF SECTION 11 BEING N 00°22'48" W AS REPORTED ON SURVEY NO. 90-050-C.

FOUND 1/4 CORNER MONUMENT IS A 2 1/2" BRASS CAP ON 1 1/4" GALV. IRON PIPE. REFERENCE: SURVEY NO. 90-050-C.

RECORD CENTERLINE CURVE DATA AND STATIONING ARE FROM OREGON STATE HIGHWAY DEPARTMENT MAP NO. 8B-34-17.

### RECORD & CURVE DATA:

2° G.R.  
TOTAL DELTA = 25°16'10"  
T.S. = 842.67'  
400' SPIRALS  
S = 4°00'00"  
a = 0.5

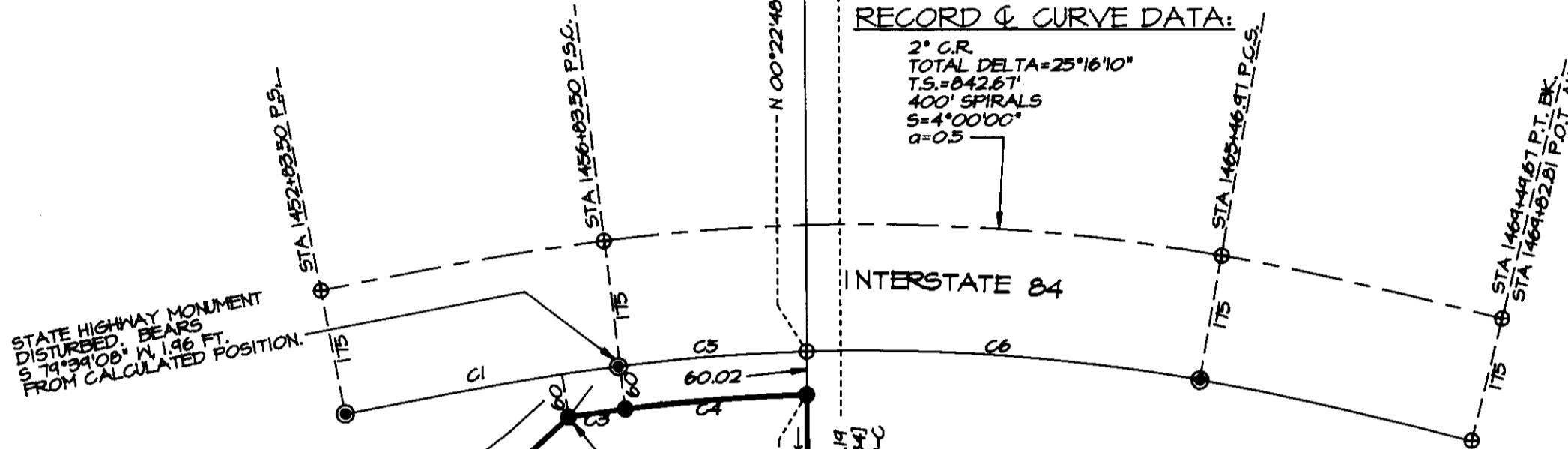

STATE HIGHWAY MONUMENT DISTURBED. BEARS S 74°39'08" W 1.96 FT. FROM CALCULATED POSITION.

SET TO DENOTE POINT ON NORTH BOUNDARY & DOES NOT REPRESENT A POINT ON COUNTY ROAD RIGHT-OF-WAY.

S 00°22'48" E 2697.19  
IS 00°22'48" E 2697.1941  
per Survey No. 90-050-C

### CURVE TABLE

NO.	DELTA	RADIUS	LENGTH	LONG CHORD
C1	175' INSIDE OFFSET SPIRAL		387.67	N 80°03'58"E 387.59
C3	235' INSIDE OFFSET SPIRAL		80.44	N 81°56'34"E 79.69
C4	5'32'59"	2629.02	254.64	N 85°31'43"E 254.54
C5	5'34'44"	2689.02	261.83	N 85°32'36"E 261.73
C6	11°41'26"	2689.02	548.66	S 85°49'20"E 547.71

### NARRATIVE OF SURVEY

THIS SURVEY WAS MADE AT THE REQUEST OF TIM McFETRIDGE TO LOCATE THE SOUTH, EAST AND NORTH LINES OF THAT TRACT OF LAND DESCRIBED IN REEL 330, PAGE 0364, DEED RECORDS OF UMATILLA COUNTY.

THE WEST SIDE OF THE PROPERTY IS BOUNDED BY THE OLD DUMP ROAD, AND COURSES ALONG THE OLD ROAD WERE NOT SURVEYED. WOOD STAKES WERE SET ALONG THE SOUTH AND EAST LINES OF THE TRACT TO ACCOMMODATE FENCE RECONSTRUCTION.

THE DESCRIPTION FOR THE SOUTH LINE OF THE PROPERTY READS "ALONG AN OLD FENCE LINE". THIS FENCE LINE EXISTED AT TIME OF THIS SURVEY AND THE LOCATION OF THE OLD FENCE LINE IS DEFINED BY THE LINE BETWEEN THE SOUTHEAST CORNER OF SECTION 11 AND THE IRON PIN SET NEAR THE WEST END OF THE SOUTH LINE, AS NOTED ON THIS RECORD OF SURVEY. THE EAST LINE OF THE PROPERTY IS THE EAST LINE OF SECTION 11. THE NORTH SIDE OF THE PROPERTY IS LOCATED PARALLEL WITH AND 60.00 FEET SOUTH OF THE SOUTH RIGHT-OF-WAY LINE OF INTERSTATE 84.

THE SOUTH RIGHT-OF-WAY LINE OF INTERSTATE 84 WAS DETERMINED AS FOLLOWS:

RECOVERED AND TIED STATE HIGHWAY MONUMENTS ON SOUTH RIGHT-OF-WAY AT CENTERLINE STATIONS 1452+83.50 P.S., 1456+83.50 P.S.C., AND 1465+46.97 P.C.S.. I FIND THE MONUMENT AT STATION 1456+83.50 IS OUT OF POSITION AS NOTED. I HOLD THE POSITIONS OF THE OTHER TWO RECOVERED MONUMENTS AND CALCULATED THE OFFSET SPIRAL AND CIRCULAR CURVES BETWEEN THEM, SCALING THE RECORD DIMENSIONS TO MATCH THE FOUND MONUMENTS HELD. THE APPLIED SCALE FACTOR ACCOUNTS FOR THE DIFFERENCES BETWEEN RECORD AND REPORTED DIMENSIONS ON THE SOUTH RIGHT-OF-WAY LINE.

THIS SURVEY WAS MADE WITH LEICA 399 GEODETIC GPS RECEIVERS USING STATIC AND REAL TIME KINEMATIC METHODS.

### LEGEND

- - SET 5/8"x30" IRON PIN WITH 1 1/2" YELLOW PLASTIC CAP MARKED "OR PLS 1106 WA PLS 17972."
- ⊙ - STATE HIGHWAY RIGHT-OF-WAY MONUMENT. FOUND A 1 1/2" ALUMINUM CAP ON A 5/8" SMOOTH IRON PIN.
- ⊕ - CALCULATED POINT ONLY NOT SET OR FOUND.
- (XOX) - RECORD DIMENSION FROM DEED, REEL 330, PAGE 0364, UMATILLA COUNTY DEED RECORDS.
- ① - APPROXIMATE LOCATION OF COUNTY ROAD NO. 433, A.K.A. COUNTY ROAD NO. 991, 40 FT. RIGHT-OF-WAY.
- C1 - DENOTES CURVE NUMBER, SEE CURVE TABLE.

### SURVEY SITE

FOUND SECTION CORNER MONUMENT IS A 2 1/2" BRASS CAP ON 1 1/4" GALV. IRON PIPE. REFERENCE: SURVEY NO. 90-050-C.

SET 5/8" BY 30" IRON PIN 2' WESTERLY OF FENCE CORNER TO DENOTE ALIGNMENT OF EXISTING FENCE BETWEEN SECTION CORNER AND COUNTY ROAD. PIN IS SET TO DENOTE EAST-WEST ALIGNMENT ONLY AND DOES NOT REPRESENT A POINT ON COUNTY ROAD RIGHT-OF-WAY.

RECEIVED BY

Umatilla County Surveyor

Date 3-99

Rec'd By JK

No. 99-29-B

VTMMCFET

REGISTERED PROFESSIONAL LAND SURVEYOR

*Will R. Wells*

OREGON  
JULY 22, 1977  
WILLIAM R. WELLS  
1106  
RENEWS 6/30/00

WILLIAM R. WELLS, PLS  
357 N.E. HWY. 11  
P.O. BOX 1696  
PENDLETON, OR 97801  
PHONE: (541) 276-6362

DATE: 02/99

DR. BY: JMW

CK. BY: WRW

NO: 99-601

PROJECT:

BOUNDARY SURVEY FOR:

TIM McFETRIDGE

LOCATED IN THE SOUTHEAST 1/4 OF SECTION 11, T2N, R32E, W4M, UMATILLA COUNTY, OREGON.