

Pacific Northwest Bell
 Tel. Pole
 N. 36° 19' W. 200.00'
 Toe of fill
 Shoulder of fill
 Set 1/2" 12" Elev. 67.05
 S. 1/4 Cor. Sec. 5, T. 2 N.; R. 32 E., W.M. Fd. 1" I.R.

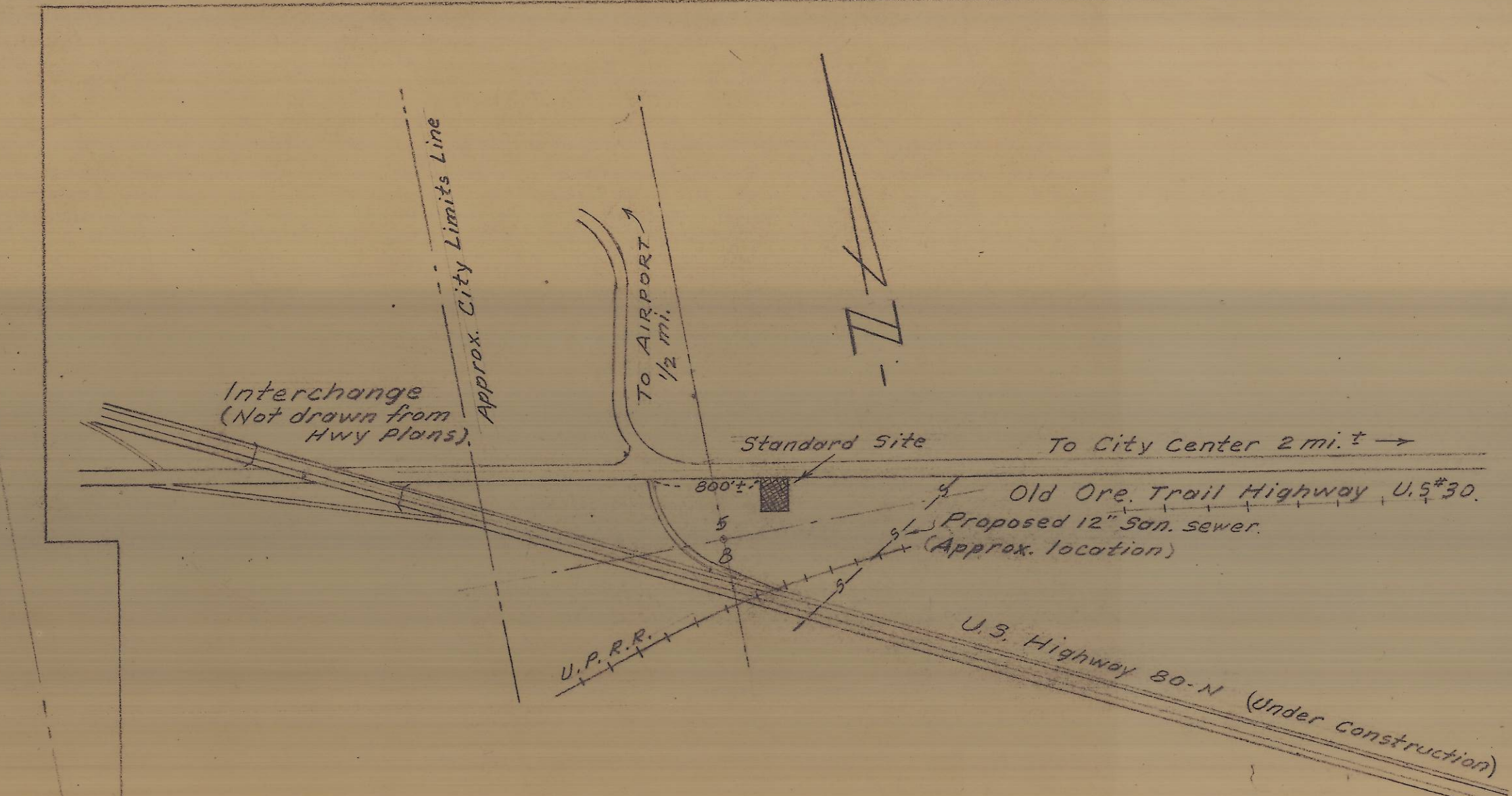

VICINITY MAP
Scale: 1"=1000'

NOTES

Building zone - Unzoned
 Fire Zone 3, Pendleton, Umatilla County, Oregon.
 Nearest sanitary sewer is about 3000 feet distant. A new 12" sewer is proposed. (See Vicinity Map) Estimated date of completion (By City Engineer) is 3 months.
 Contact Mr. Evans Dillon, Sanitation Authority on his approval of Septic tank installation.

The City has no setback requirements. Application must be made to the Oregon State Highway Department for a Permit to Construct Approach Roads. They also have their setback requirements, which will be shown on the issued permit.
 Curb design and grades controlled by the City Engineer.
 Bearings are Oregon Highway Dept., based on Ore Coordinate system North zone grid.

Elevations are U.S.C. & G.S. Datum. Add 1000 feet to shown elevations for true elevations above sea level.

There are many different types of materials in the fill which ranges in depth from 0 to 10 feet. On the surface the material is about 90% sandy alkali and 10% gravel and crushed rock. Along the south slope of the fill there are remnants of concrete footings and columns. It would be difficult to determine the bearing capacity of such a fill, not knowing the types of materials underneath or the methods of placement. The Texaco Co. which is located on the same fill is experiencing problems of settlement. The fill is about 4 years old.

LEGAL DESCRIPTION

Commencing at the intersection of the southerly right of way line of the relocated Old Oregon Trail Highway and the north and south centerlines of Section 5, Township 2 North, Range 32, thence South 30° 19' E. along said southerly right of way line 326.35 feet to the point of beginning of this description; thence continuing S. 80° 19' E. along said southerly right of way line 200.00 feet; thence at right angles S. 9° 41' W. 208.71 feet; thence at right angles N. 80° 19' W. 200.00 feet; thence at right angles N. 9° 41' E. 203.71 feet to said southerly right of way line and the point of beginning of this description.
 All being East of the Willamette Meridian, in the County of Umatilla, and State of Oregon.

Rights outstanding, if any, by virtue of the following instruments recorded in the Deed Records of Umatilla County, Oregon:
 Book 27, Page 132. U.S. Patent Homestead Cert. # 3377.
 Book 160, Page 396. City of Pendleton 20 foot wide easement for a 4" gasoline pipe line. This easement runs 5.37° 41' 30" E. and is approximately 20' S.W. of the S.W. Cor. of the above described tract.
 Book 161, Page 402. City of Pendleton to the U.S. Govt. A 20 foot wide easement for a 4" gasoline pipe line to the Pendleton Airport.
 All renewals for lease expired June 30, 1966.

REGISTERED
 OREGON
 LAND SURVEYOR
 Verl R. Phaley
 1958
 VERL R. PHALEY
 183

E-3-C

Date	No.	Revisions	By	App.
TOPOGRAPHY MAP				
FOR				
STANDARD OIL CO. OF CALIF.				
WESTERN OPERATIONS, INC.				
IN THE S.W. 1/4 OF THE S.E. 1/4 OF SEC. 5,				
T. 2 N., R. 32 E., W.M.				
Pendleton, Umatilla County, Oregon.				
Design	TENNESSEE ENGINEERING CORP.			Scale 1"=10'
Survey	412 West Second Place			Date 12-19-67
Drawn	The Dalles, Oregon			Sheet 1 of 1
Checked	Approved			Work Order No. 3742

Northwest Grocery Co.
 Concrete Block Const.
 Fin. floor elev. 88.14
 Sill height above floor +13.5'

Mountain Machinery Co.
 Temporary Bldg.
 Plywood with board floor
 Floor elev. 91.93
 Ceiling +8.0'

Union 76 Sign
 5' x 5' base - 12" high

Fd. 1 1/2" I.R. in Conc.
 N.E. Cor. of Bee Line
 Serv. Sta.
 323.71'
 Top M.H. 87.23
 Inv. 84.62
 B.M. Top North
 Flange nut on Hyd.
 Elev. 1091.30.
 Valve
 Set 1/2" 12" Elev. 89.60

8" C.I. Pipe 3' deep Service pressure 60-65 P.S.I.
 Surface flow
 Cascade Natural Gas 2" line 2' deep
 36" Wide Pavement - bituminous macadam - good condition
 S. 80° 19' E.

Inlet drain 87.68
 3 overhead wires
 Old Oregon Trail Highway (U.S. # 30) 100' R/W
 Lite Pole
 Pacific Power & Light Co 7200 V 3 ph. Δ
 Lite Pole
 Center of Sec. 5
 Conc. Mon. fd.

CONSULTING
Engineers TENNESON ENGINEERING CORPORATION

PHONE (503) 296-9177

412 WEST SECOND PLACE

THE DALLES, ORE. 97058

December 22, 1967

FIELD NOTES:

FOR: Standard Oil Company - Work Order #3742 - In the Southwest one-quarter of the Southeast one-quarter of Section 5, Township 2 North, Range 32 East, Willamette Meridian, Pendleton, Umatilla County, Oregon

CREW: Verl R. Fraley, Reg. Oregon Land Surveyor #183
Dave Tuttle, Transitman
Larry Jones, Chainman

DATES PERFORMED: December 11 & 12, 1967

WEATHER: Cold, Temp. 30°F

REFERENCE: 28"x42" Topog Map for Standard Oil Company W.O. #3742

On December 8, 1967, our firm was retained by the Standard Oil Company of California to survey and topog their service station site in Pendleton, Oregon. Before beginning the survey we met Mr. Ralph Thompson, the Umatilla County Surveyor, who was very cooperative in supplying us with maps of previous surveys & accompanied us to the field to show us the South one-quarter corner and the center one-quarter corner of Section 5. He also gave us an elevation of a Bench Mark which had been established by the Highway Department.

We began the survey by establishing a true line between the South one-quarter corner of Section 5, which is a 1 inch iron rod in a North-South fence line, and the center of Section 5, which is a concrete monument located in a East-West fence line about 18 feet East of a fence corner.

From the South one-quarter corner of Section 5 we measured 468.16 feet to an intersection with the Southerly right-of-way line of the Old Oregon Trail Highway (U.S. #30), where we found a one-half inch iron rod. At the centerline of said highway we also found a concrete nail on line. Previous surveys in the area gave the bearing of the North-South centerline of Section 5 as North 0° 54' 23" West. I was told this is an Oregon State Highway grid bearing. This also conforms to the bearing system used by Wayne Harris on his survey in 1964 of the Standard Oil Tract (then owned by Joe Hawkins).

FIELD NOTES

FOR: Standard Oil Company - Work Order #3742

December 22, 1967

At the intersection of the South right-of-way line of the Highway and the North-South centerline of Section 5, we turned a delta angle of 100° 35' 23" to the right, to the Highway bearing of South 80° 19' East which is also by Deed Call. At 326.85 feet, which is by deed call we set a railroad spike for the Northwest corner of the tract. Continuing for 200 feet we set an iron rod for the Northeast corner of the tract. For a check on our work, we measured on additional 328.71 feet along the right-of-way line to the Northeast corner of the "Beeline" Service Station where we found a 1 1/2" iron pins set in concrete. We then set the Southwest and Southeast corners of the tract where we set an iron rod at each.

Bearings are Oregon Highway Department, based on Oregon Coordinate System North Zone Grid.

Monuments found and set on this survey are shown on the attached map, Work Order #3742, which is by reference is made a part of these surveys.

I certify that this work was done under my direct supervision.

SIGNED Verl R. Fraley
Verl R. Fraley Oregon Land Surveyor #183

CHECKED AND APPROVED

TENNESON ENGINEERING

Donald J. Branton
Donald J. Branton, President

