

# OREGON CORNER RESTORATION FORM

T2N R28E Z1

Section 31, Township 2N, Range 28E,  
 County Umatilla, Date March 30, 2005.

- Condition Report
- Not Found
- Remonumented
- Unrecorded
- Surveyed in
- Referenced out

Township corner common to Townships 1 and 2 North  
 Ranges 27 and 28 East, W.M., Umatilla County, Oregon.

Previous Renewals / Surveys, etc.

The corner was originally set by David P. Thompson under Contract No. 83 dated July 22, 1859. His record Reads: Set post for corner to Townships Nos. 1 and 2 North of Ranges 27 and 28 East in mound of earth &c as per instructions.

Monument and accessories found: (Condition and source)  
 None.

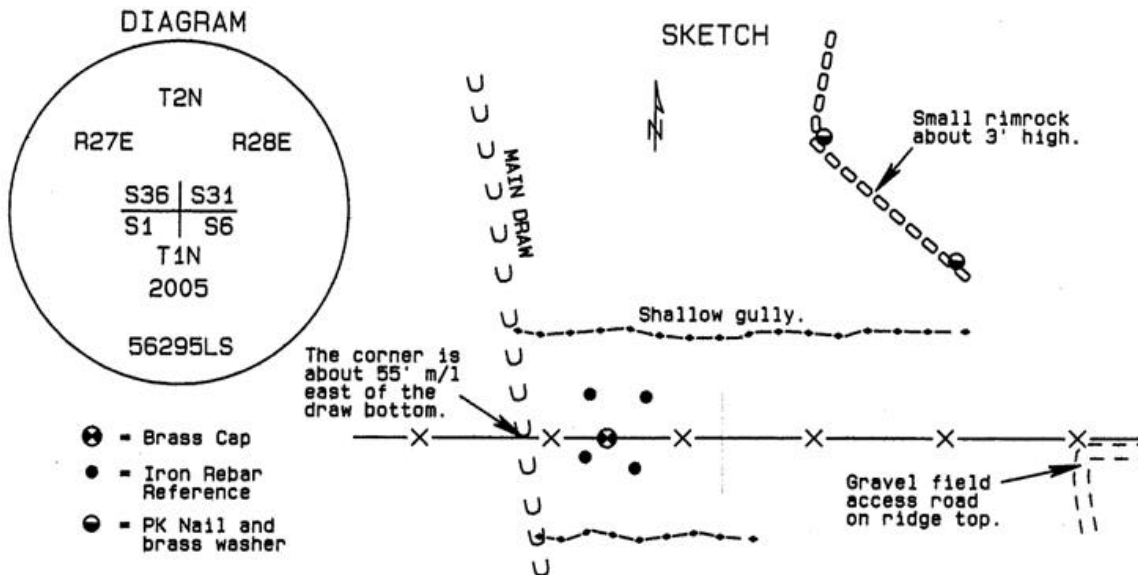

Monument and accessories set: (Procedures and description)

At the proportionate point I set 2 3/8" x 30" galvanized iron pipe with a 2 3/8" brass cap stamped as shown above 30" in the ground with a 24" collar of stone. This point falls under the existing fence. I drove a 6' steel post approximately 1 foot west with a County Monument sign attached.

For references I set four 5/8" x 24" green coated iron rebars with 1.25" orange plastic caps attached stamped WTS and 56295LS. I also set two pk nails with 1 1/2" brass washers stamped WTS and 59295LS attached under a mound of stone on top of a small rimrock that is approximately 3 feet high:

- an iron rebar bears N43°15'26"E 37.56 feet approximately 18" below the surface;
- an iron rebar bears N21°28'12"W 31.30 feet approximately 18" below the surface;
- an iron rebar bears S49°10'05"W 19.04 feet approximately 18" below the surface;
- an iron rebar bears S42°45'33"E 27.18 feet approximately 18" below the surface;
- a pk nail with brass washer bears N19°30'28"E 426.58 feet;
- a pk nail with brass washer bears N45°37'14"E 413.35 feet;

Control was established with a Trimble R7/R8 GPS system using static methods. The monument was set with a Trimble 5601 Robotic Total Station. Bearings and distances are grid.

Location and Comments  
 SPC Oregon North, NAD 83-91  
 Northing = 707,911.45 ft  
 Easting = 8,490,644.84 ft

Compass Declination

Surveyor's Seal

Witnessed By:  
 RECEIVED BY:  
 Umatilla County Surveyor  
 Date: 5-05  
 Rec'd By: KK  
 No. 05-111-C

Firm / Agency  
 Witness Tree Surveying  
 P.O. Box G  
 Pilot Rock, OR 97868  
 Party Chief  
 Stephen K. Haddock, PLS

REGISTERED  
 PROFESSIONAL  
 LAND SURVEYOR

*Stephen K. Haddock*  
 OREGON  
 JULY 9, 2001  
 STEPHEN K. HADDOCK  
 56295LS

RENEWAL DATE 6-30-06