

OREGON CORNER RESTORATION FORM

COUNTY: Umatilla. DATE: 03/20/20.

CORNER DESIGNATION: A-17, The Northeast corner of Section 3, Township 1 North, Range 31 East, W.M.

PREVIOUS RENEWALS/SURVEYS ETC: Corner was originally established by Josiah A. Burnett under Contract No. 92 dated September 12, 1860. Notes state: Set post for Cor. To Sec's. 2, 3, 34 and 35, drove charred stake and raised mound with trench as per instructions. John Kimbrell, County Surveyor, in his January, 1909 Survey No. 274, recovered this corner but does not state what was found for the corner. Kimbrell's Survey No. 274 is found in the Record of Private Survey Books.

MONUMENT AND ACCESSORIES FOUND: Found several stones buried 18" below ground line, 2 1/2' South of the ancient Township fence running East-West. The 8 by 6 by 4" stone was lying flat but has 2 grooves on it. The stones are in a dirt berm.

MONUMENT MARKING DETAIL:

T2N R31E
S34|S35

S3|S2
· T1N
2020
54657PLS

MONUMENT SET: At the position of the grooved stone, set a 2 1/2" brass cap on 1 1/4 by 30" galvanized iron pipe 26" in the ground. Cap is marked as shown in Monument Marking Detail. Wired Witness sign to a steel fence post in the East-West fence line, 2 1/2' North of corner monument.

New accessories:

A 5/8 by 24" rebar with blue plastic cap marked "Wells Surveying 54657PLS" bears N 86°21' E, 37.2'.
A 5/8 by 18" rebar with blue plastic cap marked "Wells Surveying 54657PLS" bears N 82°35' E, 15.7'.
A 5/8 by 24" rebar with blue plastic cap marked "Wells Surveying 54657PLS" bears N 84°30' W, 18.1'.
A 5/8 by 24" rebar with blue plastic cap marked "Wells Surveying 54657PLS" bears N 88°03' W, 41.9'.
The rebar accessories are set near an East-West fence line. Wired bearing object signs to each of the rebar accessories.

Bearings to accessories are State Plane Grid bearings.

LOCATION AND COMMENTS:

Corner falls just South of an East-West fence line. The area to the South has been farmed in the past.

OREGON STATE PLANE COORDINATE, North Zone NAD 83(91), International Feet Units:

N: 709780.20
E: 8608385.78

FIRM: Wells Surveying
P.O. Box 1696
Pendleton, OR 97801

Surveyor's Seal

\1N31A-17

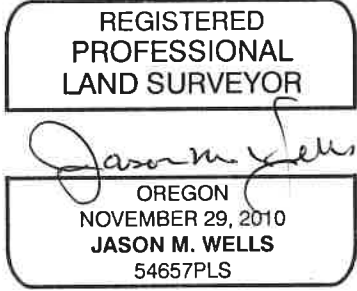

RENEWS: 6, 30, 20

20-043-C