

**OREGON CORNER RESTORATION FORM**

COUNTY: Umatilla. DATE: 03/12/20.

CORNER DESIGNATION: C-1, The West One-Quarter corner of Section 6, Township 1 North, Range 31 East, W.M.

PREVIOUS RENEWALS/SURVEYS ETC: Corner was originally established by David P. Thompson under Contract No. 81 dated July 8, 1859. Notes state: Set post for 1/4 Sec. Corner and build mound of stone.

MONUMENT AND ACCESSORIES FOUND: None. Reestablished corner position by single proportion measurement between the Northwest and Southwest corners of Section 6. The corner area has been previously farmed and is now in active CRP. There is a fence corner with fences extending West and South about 160' South of the corner point.

**MONUMENT MARKING DETAIL:**

T1N  
R30 E | R31E  
1/4  
S1|S6  
2020  
54657PLS

MONUMENT SET: A reestablished corner position, set a 2 1/2 brass cap on 1 1/4 by 30" galvanized iron pipe 28" in the ground. Brass cap is marked as shown in Monument Marking Detail. Set steel fence post 1 1/2' South of corner and attached Witness sign.

**New accessories:**

- A silver Deep-1 magnet bears N 41°15' E, 29.0'.
- A purple Deep-1 magnet bears S 49°32' E, 35.4'.
- A blue Deep-1 magnet bears S 44°07' W, 27.1'.
- A orange Deep-1 magnet bears N 42°06' W, 28.9'.

Buried bearing object signs with the Deep-1 magnets which are buried 18" below ground line. Bearings to corner accessories are State Plane Grid bearings.

LOCATION AND COMMENTS: Corner falls on a North facing hillside about 160' North of a fence corner with fences South and West.

**OREGON STATE PLANE COORDINATE, North Zone NAD 83(91), International Feet Units:**

N: 706934.47  
E: 8586773.26

FIRM: Wells Surveying  
P.O. Box 1696  
Pendleton, OR 97801

Surveyor's Seal

\N31C-1

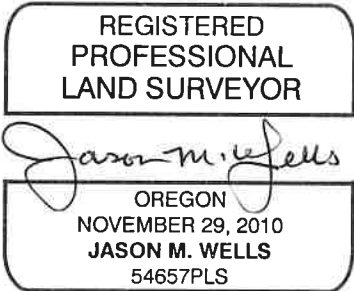

RENEWS: 6:30:20

20-043-C