

OREGON CORNER RESTORATION FORM

COUNTY: Umatilla. DATE: 03/20/20.

CORNER DESIGNATION: C-17, The East One-Quarter corner of Section 3, Township 1 North, Range 31 East, W.M.

PREVIOUS RENEWALS/SURVEYS ETC: Corner was originally established by Josiah A. Burnett under Contract No. 92 dated September 12, 1860. Notes state: Set post for 1/4 Sec. Cor., drove charred stake and raised mound with trench as per instructions. John Kimbrell, County Surveyor, in his January, 1909 Survey No. 274, reestablished this corner and set an iron piece from an old Sulky plow for the corner. Kimbrell's Survey No. 274 is found in the Record of Private Survey Books.

MONUMENT AND ACCESSORIES FOUND: Found set iron piece of old Sulky plow.

MONUMENT MARKING DETAIL:

T1N R31E
1/4
S3|S2
2020
54657PLS

MONUMENT SET: At the position of the plow piece, set a 2 1/2" brass cap on 1 1/4 by 30" galvanized iron pipe 30" in the ground. Cap is marked as shown in Monument Marking Detail. Wired Witness sign to the plow piece and placed it on the South side of the corner monument.

New accessories:

A 5/8 by 24" rebar with blue plastic cap marked "Wells Surveying 54657PLS" bears N 05°17' E, 17.2'.
A 5/8 by 18" rebar with blue plastic cap marked "Wells Surveying 54657PLS" bears S 57°54' E, 26.4'.
A 5/8 by 24" rebar with blue plastic cap marked "Wells Surveying 54657PLS" bears S 20°18' W, 29.7'.
A 5/8 by 24" rebar with blue plastic cap marked "Wells Surveying 54657PLS" bears N 59°30' W, 31.5'.
Wired bearing object signs to each of the rebar accessories.
Bearings to accessories are State Plane Grid bearings.

LOCATION AND COMMENTS:

Corner falls on the East side of a swale. The area West of the corner has been farmed.

OREGON STATE PLANE COORDINATE, North Zone NAD 83(91), International Feet Units:

N: 707035.12
E: 8608458.78

FIRM: Wells Surveying
P.O. Box 1696
Pendleton, OR 97801

Surveyor's Seal

\1N31C-17

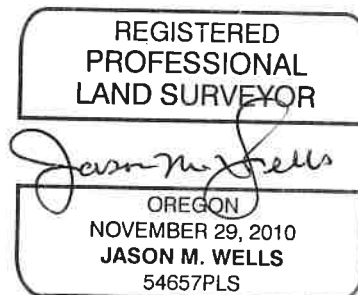

RENEWS: 6/30/20

20-043-C