

OREGON CORNER RESTORATION FORM

COUNTY: Umatilla. DATE: 03/12/20.

CORNER DESIGNATION: C-5, The East one-quarter Section corner of Section 6, Township 1 North, Range 31 East, W.M.

PREVIOUS RENEWALS/SURVEYS ETC: Corner was originally established by Josiah A. Burnett under Contract No. 92 dated September 12, 1860. Notes state: Set a post for 1/4 Sec. Cor., corner, drove charred stake and raised mound with trench as per instructions.

MONUMENT AND ACCESSORIES FOUND: None. Corner falls in an active CRP field. Reestablished corner position by single proportion measure between the Northeast and Southeast corners of Section 6.

MONUMENT MARKING DETAIL:

T1N R31E
1/4
S6|S5
2020
54657PLS

MONUMENT SET: At reestablished corner position, set a 2 1/2" brass cap on 1 1/4 by 30" galvanized iron pipe 28" in the ground. Cap is marked as shown in Monument Marking Detail. Set steel fence post 1 1/2' South of corner and attached Witness sign.

New accessories:

- A silver Deep-1 magnet bears N 39°46' E, 28.5'.
 - A purple Deep-1 magnet bears S 43°13' E, 31.7'.
 - A blue Deep-1 magnet bears S 31°58' W, 29.7'.
 - A orange Deep-1 magnet bears N 36°07' W, 29.7'.
- Buried bearing object signs with the Deep-1 magnets which are buried 18" below ground line. Bearings to accessories are State Plan Grid bearings.

LOCATION AND COMMENTS: Corner is located on a North facing slope about 100' South of a farm road and stock fence.

OREGON STATE PLANE COORDINATE, North Zone NAD 83(91), International Feet Units:

N: 706805.90
E: 8592707.39

FIRM: Wells Surveying
P.O. Box 1696
Pendleton, OR 97801

Surveyor's Seal

\\N31C-5

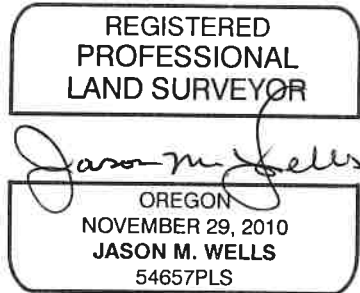

RENEWS: 6:30:20