

OREGON CORNER RESTORATION FORM

COUNTY: Umatilla. DATE: 03/06/20.

CORNER DESIGNATION: J-3, The South One-Quarter Section corner of Section 7, Township 1 North, Range 31 East, W.M.

PREVIOUS RENEWALS/SURVEYS ETC: Corner was originally established by Josiah A. Burnett under Contract No. 92 dated September 12, 1860. Notes state: Set a post for 1/4 Sec. Cor., corner., drove charred stake and raised mound with trench as per instructions.

MONUMENT AND ACCESSORIES FOUND: None. The area has been farmed.

MONUMENT MARKING DETAIL:

T1N R31E
S7
1/4 -----
S18
2020
54657 PLS

MONUMENT SET: Reestablished corner position on the parallel of latitude by single proportion measurement between the Northeast and Northwest corners of Section 18. At the reestablished corner position, set a 2 1/2" brass cap on 1 1/4 by 30" galvanized iron pipe 20" in the ground. Cap is marked as shown in the Monument Marking Detail.

New accessories:

- A silver Deep-1 magnet bears N 39°24' E, 25.4'.
- A purple Deep-1 magnet bears S 68°04' E, 33.8'.
- A silver Deep-1 magnet bears S 03°59' W, 32.9'.
- A silver Deep-1 magnet bears S 87°01' W, 24.7'.

Buried bearing object signs with the Deep-1 magnets which are buried 18" below ground line. Set a steel fence post 1 1/2' Southeast of corner monument with Witness sign wired to it. Bearings to accessories are State Plane Grid bearings.

LOCATION AND COMMENTS: Corner falls on ridge top in farmed area, at the South edge of a field currently in CRP.

OREGON STATE PLANE COORDINATE, North Zone NAD 83(91), International Feet Units:

N: 698953.52
E: 8590218.93

FIRM: Wells Surveying
P.O. Box 1696
Pendleton, OR 97801

Surveyor's Seal

\1N31J-3

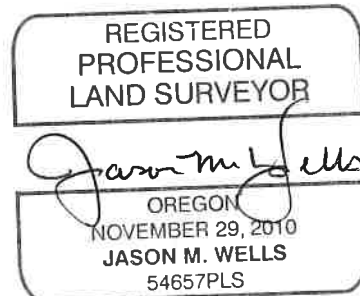

RENEWS: 6:30:20

20-043-C