

OREGON CORNER RESTORATION FORM

Section 7 Township 1N Range 32E
 County Umatilla Date: December 23, 2009

Corner Designation: 1N32G1

Condition Report Only
 Not found

Quarter corner to section 12, R31E, and Section 7, R32E,
 T1N, W.M., Umatilla County, Oregon

Remonumented
 Unrecorded
 Surveyed in
 Referenced out

Previous Renewals / Surveys, etc.

Corner originally set by Josiah A. Burnett under contract No. 92 Dated September 12, 1860.
 His record reads: Set a post for 1/4 sec. cor., drove charred stake and raised mound with trench
 as per instructions. In the record of Private Surveys Book 2, Page 95, Geary Kimbrell states: Set
 stone 24"x14"x13 ins. for 1/4 sec. cor.

Monument and Accessories found: (condition and source)
 None.

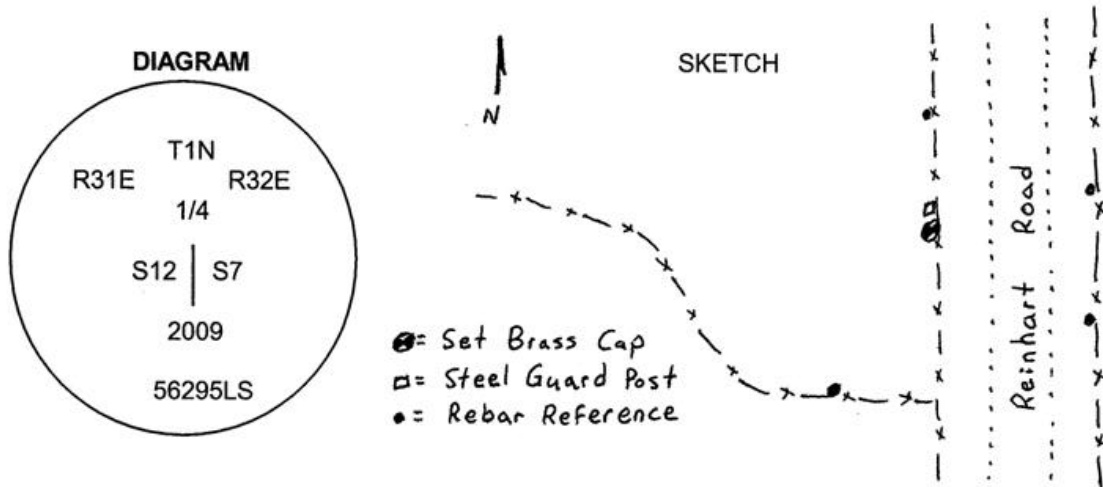

MONUMENT (S) AND ACCESSORIES SET (Procedures and Description)

Set a 1 1/2" x 30" Galvanized Iron Pipe with a 2 1/2" brass cap stamped as shown in the diagram above at the proportionate point. The cap is flush with the surface of the ground. I set a 6' steel guard post with a County Monument sign along side.

For references, I set four 5/8" by 24" iron rebars with 1 1/4" Orange plastic caps stamped WTS and 56295LS as described below:

- an iron rebar bears S45°11'40"E, 56.22 feet;
- an iron rebar bears S59°16'11"W, 74.99 feet;
- an iron rebar bears N01°04'20"E, 43.83 feet;
- an iron rebar bears N77°01'24"E, 40.76 feet;

The monument was set and references tied using a Trimble R7/R8 RTK GPS system.

Location and comments
 NAD 83/1991 State Plane Coordinate
 Oregon North Zone
 N=701,969.19 ft
 E=8,619,109.16 ft

Compass Declination

Surveyors Seal

RECEIVED BY:
Umatilla County Surveyor
 Date: 6-10
 Rec'd By: KK
 No. 10-93-C

Witness Tree Surveying
 Address
 P.O. Box G
 Pilot Rock, Or. 97868
 Party Chief
 Stephen K, Haddock

REGISTERED
 PROFESSIONAL
 LAND SURVEYOR

Stephen K. Haddock

OREGON
 JULY 9, 2001
 STEPHEN K. HADDOCK
 56295LS

RENEWAL DATE 6-30-11