

OREGON CORNER RESTORATION FORM

Section 16 Township 1N Range 32E
 County Umatilla Date: December 12, 2009

Corner Designation: 1N32L13

Condition Report Only
 Not found

Quarter corner common to sections 16 and 15,
 T1N, R32E, W.M., Umatilla County, Oregon.

Remonumented
 Unrecorded
 Surveyed in
 Referenced out

Previous Renewals / Surveys, etc.

Corner originally set by Daniel Chaplin under contract No. 107 Dated September 21, 1864.
 His record reads: Set post for 1/4 section corner in mound of earth with charred stake,
 pits, etc., as per instructions. In Partition Plat 2009-19, Bill Wells calculated a position for this
 corner but did not monument it.

Monument and Accessories found: (condition and source)

None. The position falls under a fence which runs south and northwest.

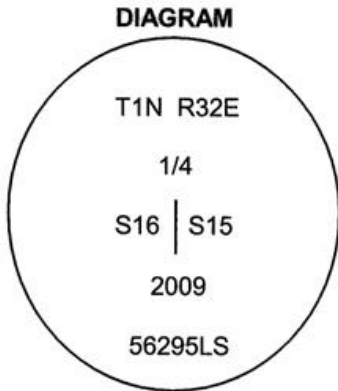

SKETCH

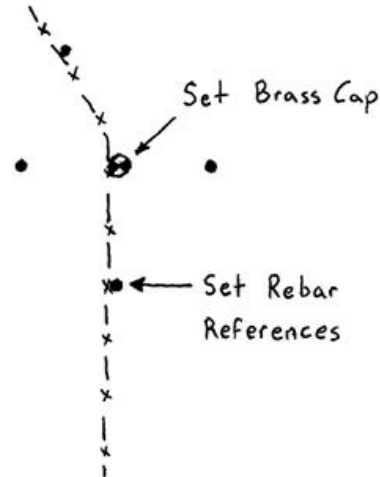

MONUMENT (S) AND ACCESSORIES SET (Procedures and Description)

Set a 1 1/2" x 30" galvanized iron pipe with a 2 1/2" brass cap stamped as shown in the diagram
 above at the point held by Partition Plat 2009-19.

For references, I set four 5/8" by 24" iron rebars with 1 1/2" orange plastic caps stamped WTS
 and 56295LS as described below:

- an iron rebar bears N05°59'42"W, 14.79 feet in the existing fence;
- an iron rebar bears N68°15'42"E, 46.82 feet, 2 feet below the surface of a CRP field.
- an iron rebar bears S02°18'00"E, 25.53 feet in the existing fence;
- an iron rebar bears S84°52'18"W, 46.59 feet;

The monument was set and references tied using a Trimble R7/R8 RTK GPS system.

Location and comments
 NAD 83/1991 State Plane Coordinate
 Oregon North Zone
 N = 697,004.61 ift
 E = 8,635,496.29 ift

Compass Declination
 Firm / Agency
 Witness Tree Surveying
 Address
 P.O. Box G
 Pilot Rock, Or 97868
 Party Chief
 Stephen K, Haddock

Surveyors Seal

RECEIVED BY:
 Umatilla County Surveyor
 Date: 6-10
 Rec'd By: KE
 No. 10-63-C

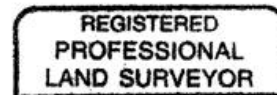

Stephen K. Haddock

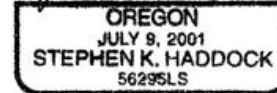

RENEWAL DATE 6-30-11