

OREGON CORNER RESTORATION FORM

Section 25 Township 1N Range 32E
 County Umatilla Date: July 6, 2009

Corner Designation: 1N32T25

East quarter corner of section 25 only, T1N, R32E, W.M.,
 Umatilla County, Oregon

Condition Report Only
 Not found
 Remonumented
 Unrecorded
 Surveyed in
 Referenced out

Previous Renewals / Surveys, etc.

Corner originally set by David P. Thompson under contract No. 106 Dated August 16, 1864. His record reads: Set post for 1/4 sec. corner in mound of earth with charred stake, pits and trench. Zenas Moody under contract No. 164 dated September 21, 1871 states: Set post and made mound of earth. James Currin and James Noland under special contract dated May 4, 1887 state: Found pits and mound. Set a basalt stone, 12x10x10 marked 1/4 on west face and raised earth mound. Lincoln Wilkes in his 1917 resurvey states: set an iron post, 3 ft. long, 2 ins. diam. with brass cap.

Monument and Accessories found: (condition and source)
 None. The point has been destroyed by fence construction.

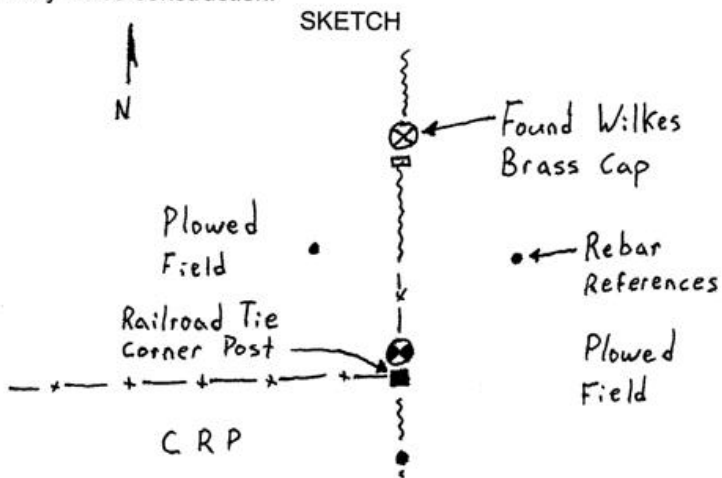
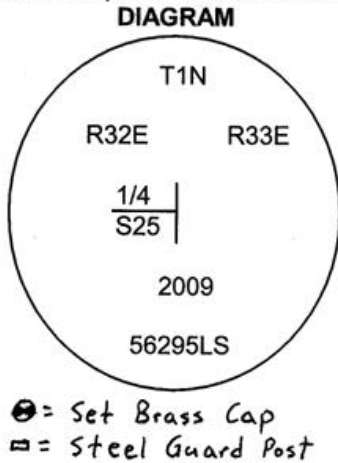

MONUMENT (S) AND ACCESSORIES SET (Procedures and Description)

At the proportionate point, approximately 15" north of the fence corner post I set a 1 1/2" x 30" galvanized iron pipe with a 2 1/2" brass cap stamped as shown in the diagram above.

For references I set three 5/8"x24" iron rebars with 1 1/4" orange plastic caps attached stamped WTS and 56295LS as follows:

- an iron rebar bears S01°10'57"W 34.21 feet 2 feet below the surface;
- an iron rebar bears N41°08'41"W 53.98 feet, 2 feet below the surface;
- an iron rebar bears N37°13'47"E 49.45 feet, 2 feet below the surface;

The Lincoln Wilkes brass cap for the closing 1/4 corner to Section 30, T1N, R33E, bears N00°00'51"E 76.32 feet;

The monument was set and references were tied using a Trimble R7/R8 RTK GPS system.

Location and comments
 NAD 83/1991 State Plane Coordinate
 Oregon North Zone
 N=686,678.48 ft
 E=8,651,561.52 ft

Compass Declination
 Firm / Agency
 Witness Tree Surveying
 Address
 P.O. Box G
 Pilot Rock, Or. 97868
 Party Chief
 Stephen K, Haddock

Surveyors Seal

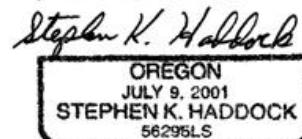
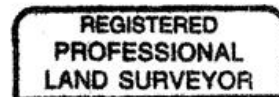

RENEWAL DATE 6-30-11

RECEIVED BY:
 Umatilla County Surveyor
 Date: 6-10
 Rec'd By: KK
 No. 10-93-C